

Project Data

Customer:

Project Date: 25.11.2024

Offer No.: Jan

Production Order No.: 95_

Project Name: Living_AP95.S3D

Made by: Ionut

Material:	Y244_FS08_18	Code: FKY244_FS08_18	Thickness	18 mm
-----------	--------------	----------------------	-----------	-------

Rail Cuier Oliv

Spate

Notes:

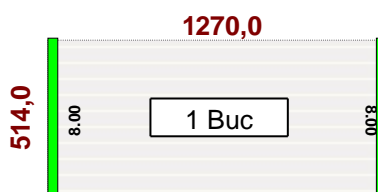
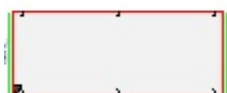

CNC1: 
10000000190

Rail Cuier Oliv

Laterală_ST_down

Notes:

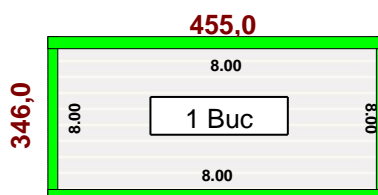
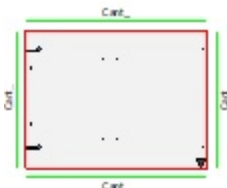

CNC1: 
10000000191

Rail Cuier Oliv

Laterală_DR_Up

Notes:

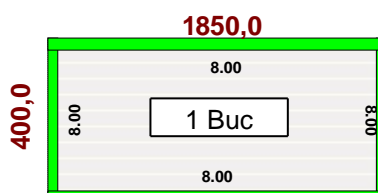

CNC1: 
10000000192

Rail_Cuier_Oliv

Fund

Notes:

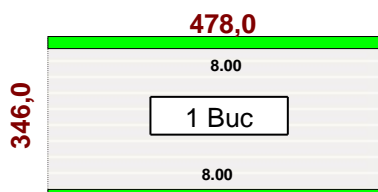
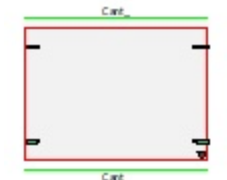

CNC1: 
10000000193

Rail Cuier Oliv

Laterală_Dr_down

Notes:

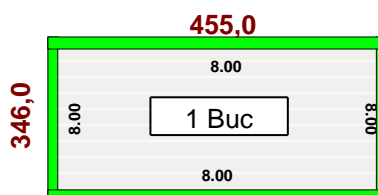
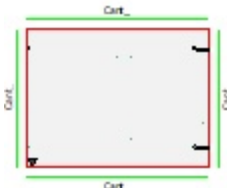

CNC1: 
10000000194

Rail_Cuier_Oliv
Lateral_St_Up
Notes:

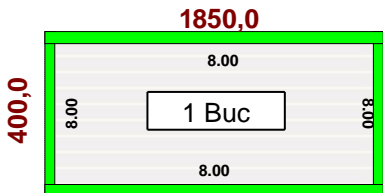

Rail Cuier Oliv
Front
Notes:

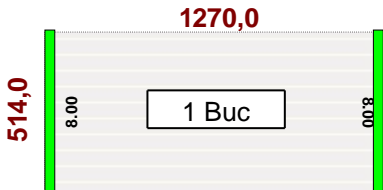
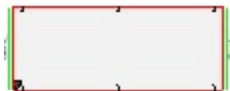

Rail_Cuier_Oliv
Fund1
Notes:

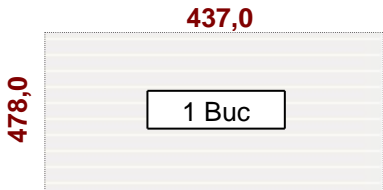

Rail Cuier Oliv
CXapac_Down
Notes:

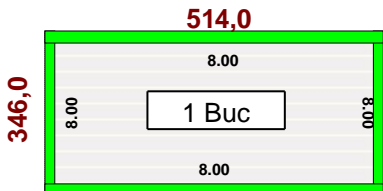
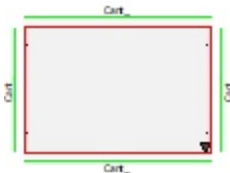

Rail_Cuier_Oliv
Fund_Up
Notes:

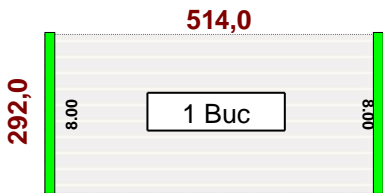

Rail Cuier Oliv
Paz_St_Up
Notes:

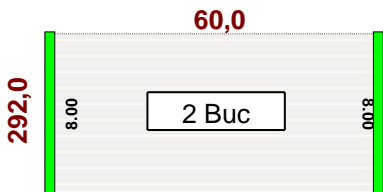

Rail Cuier Oliv
Pol_Up
Notes:

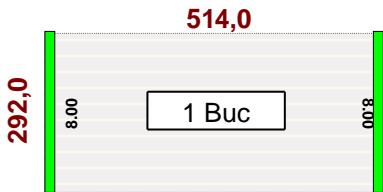
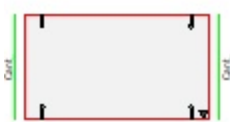

Rail Cuier Oliv
Polita
Notes:

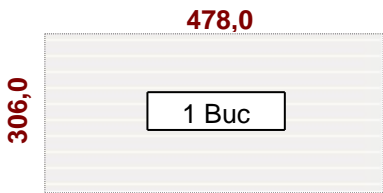

Front0
FRD
Notes:

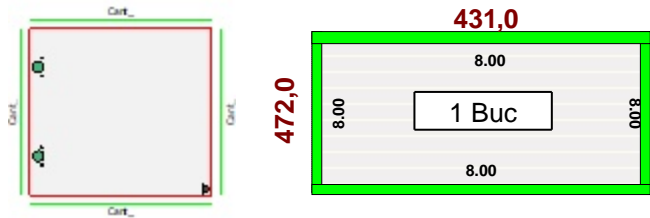

Material:	Y351_FS08_18	Code:	FKY351_FS08_18	Thickness	18 mm

TV Unit
Lateral ST_Box1
Notes:

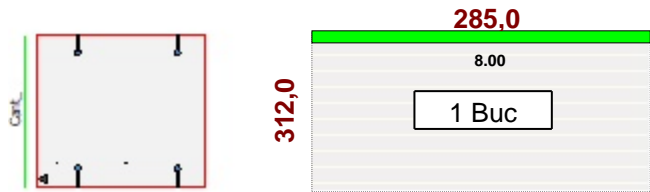

TV Unit
Lateral DR_Box
Notes:

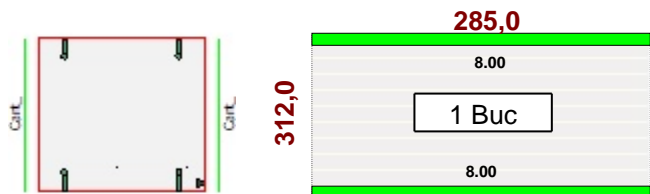

TV Unit
Fund_Box1
Notes:

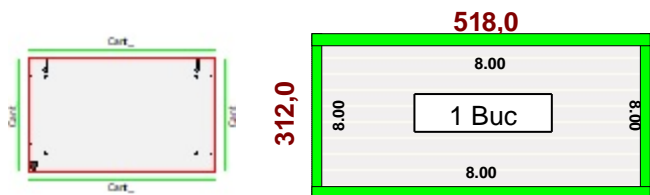

TV Unit
Lateral ST_Box
Notes:

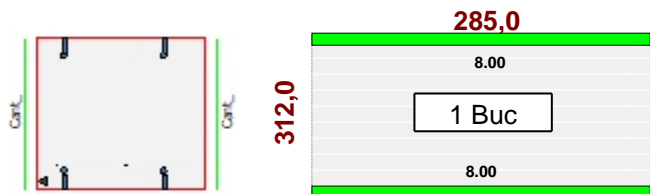

TV Unit
Lateral DR_Box2
Notes:

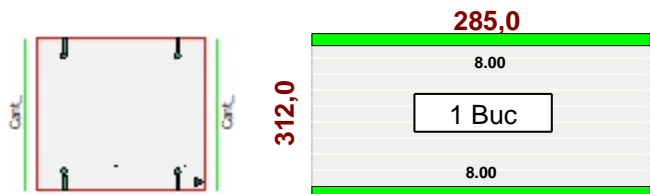

TV Unit
Fund_Box2
Notes:

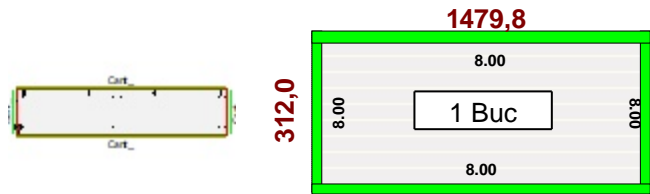

TV_Unit

Lateral ST_Box3

Notes:



312,0

285,0

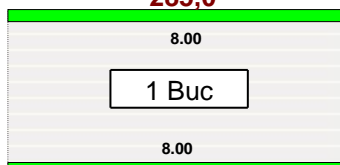

CNC1:

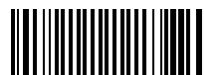

110000000041

TV_Unit

Fund_Box3

Notes:

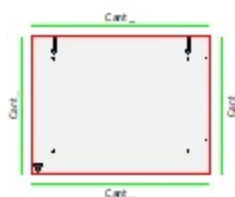

312,0

406,2

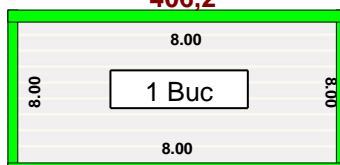
**TV_Unit**

Lateral DR_Box3

Notes:

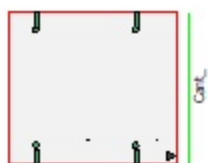

312,0

285,0

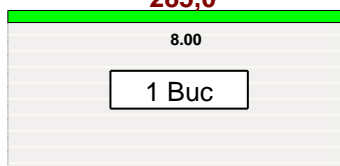

CNC1:



120000000043

TV_Unit

Top_Box1

Notes:



330,0

518,0

**TV_Unit**

Top_Box2

Notes:



330,0

1479,8

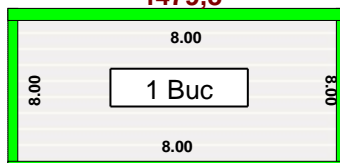

CNC1:



220000000045

TV_Unit

Top_Box3

Notes:

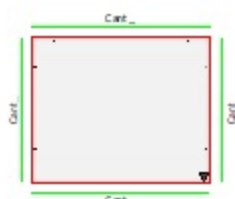

330,0

406,2

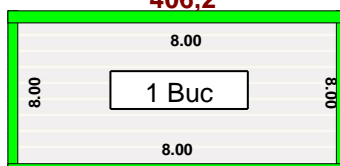
**TV_Unit**

Panou_st

Notes:



330,0

2113,0

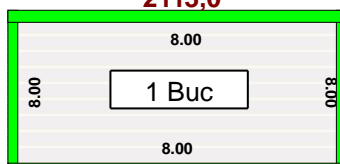
**TV_Unit**

Panou_dr

Notes:



330,0

2113,0

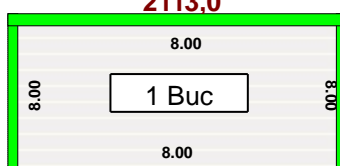

CNC1:



210000000048

TV_Unit

Top_9

Notes:

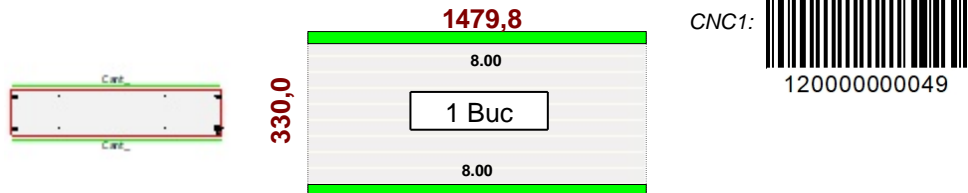

TV_Unit

Polita_10

Notes:

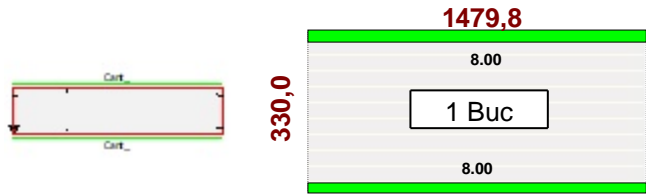

TV_Unit

Polita_1

Notes:

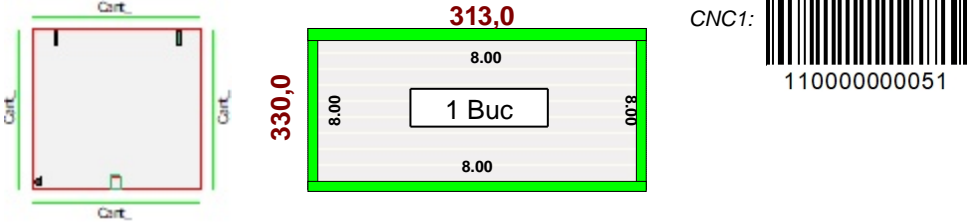

TV_Unit

Polita_3

Notes:

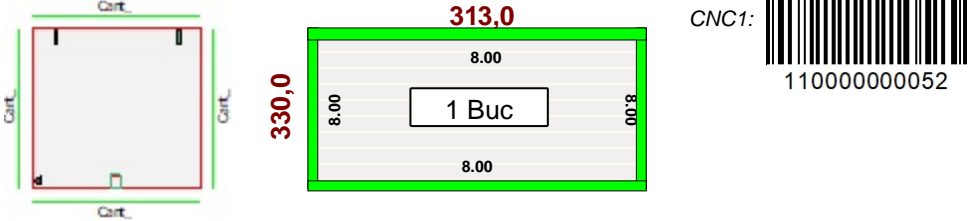

TV_Unit

Stalp_st

Notes:

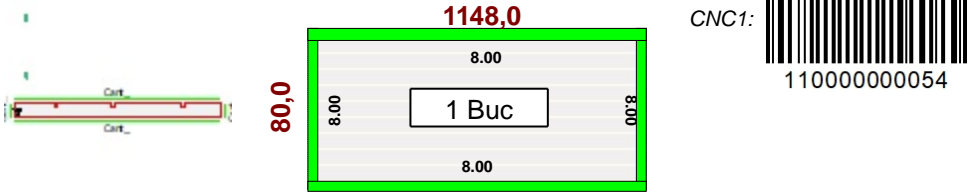

TV_Unit

Stalp_dt

Notes:

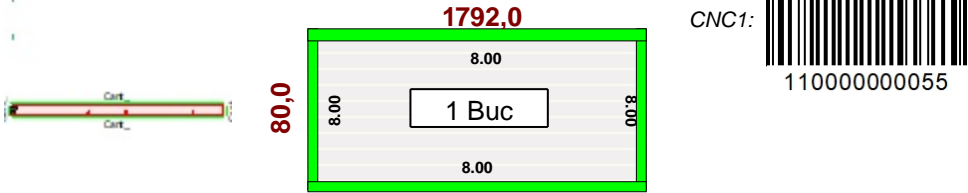

TV_Unit

Polita_8

Notes:

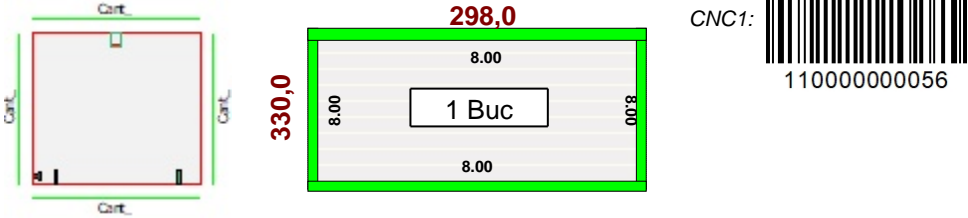

TV_Unit

Polita_7

Notes:

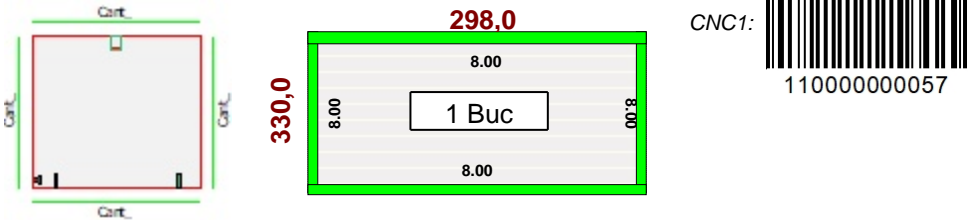

TV_Unit
Polita_11
Notes:

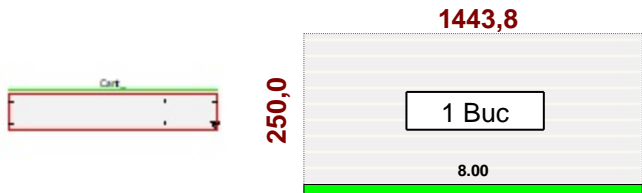

TV_Unit
Divizor_6
Notes:

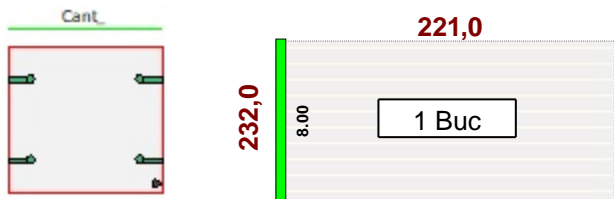

TV_Unit
Divizor_5
Notes:

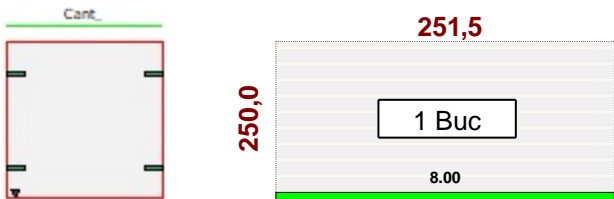

TV_Unit
Spat_Plin_Box1
Notes:

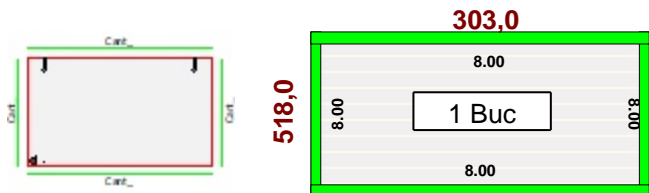

TV_Unit
Divizor_3
Notes:

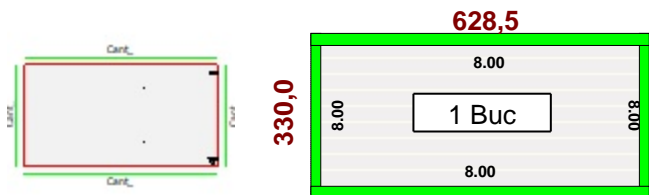

TV_Unit
Divizor_4
Notes:

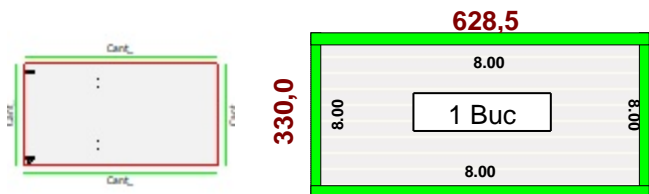

TV_Unit
Spat_box_up
Notes:

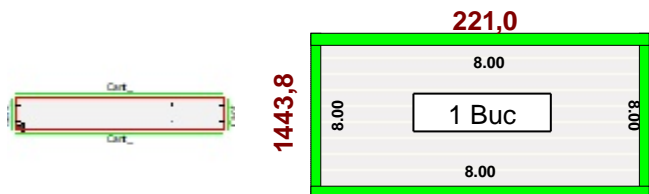

TV_Unit
Divizor_Box2
Notes:

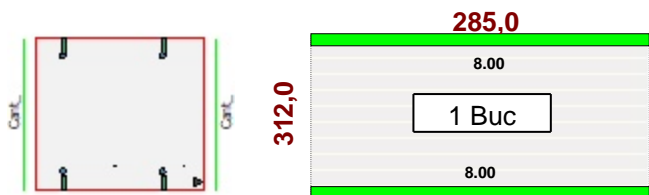

TV_Unit

Divizor_1

Notes:

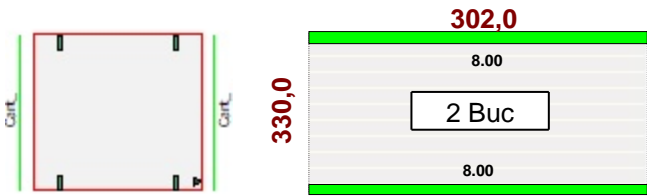

TV Unit

Spate_Plin_Box2

Notes:

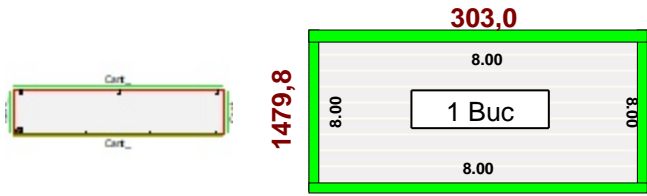

TV_Unit

Spate_Plin_Box3

Notes:

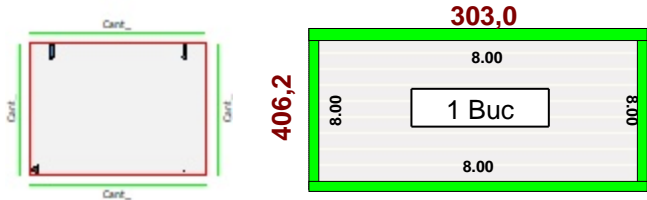

Front0

FR

Notes:

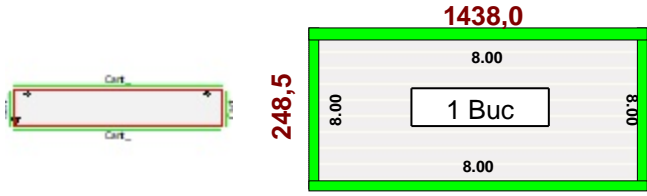

Front sertar

Front_legra

Notes:

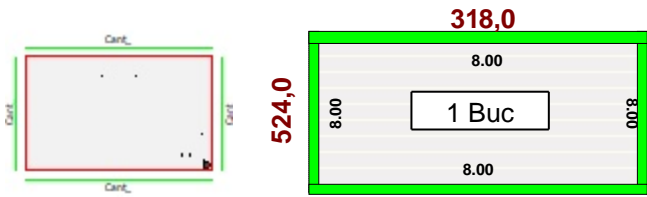

Front sertar

Front_legra

Notes:

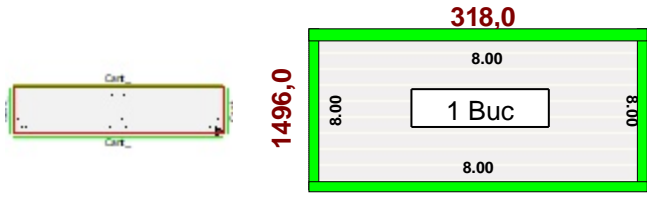

Front sertar

Front_legra

Notes:

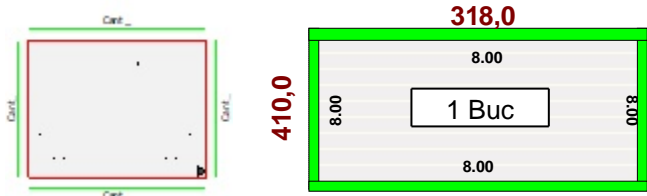

Filler

Fr

Notes:

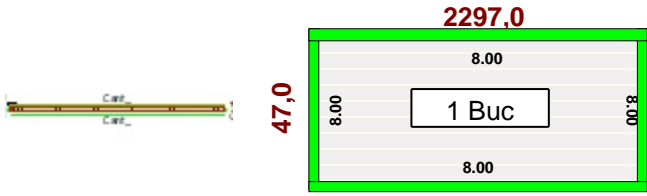

Front_st1
front_stanga
Notes:

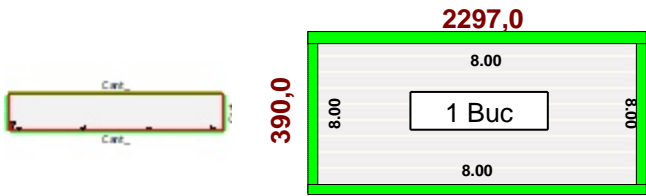

Front
Front_MSR_MSU
Notes:

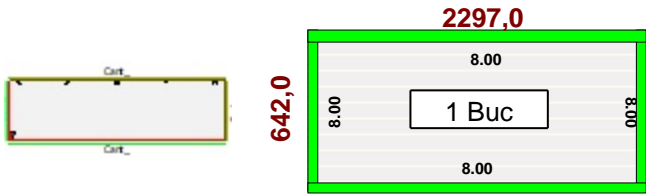

Front_dt1
Front_Dulap_ST
Notes:

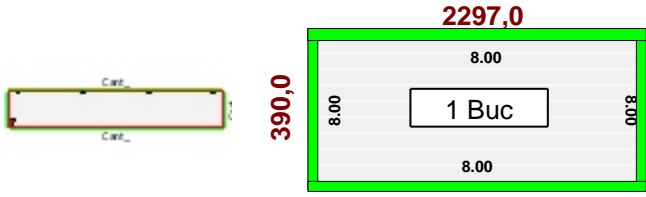

Filler
FR
Notes:

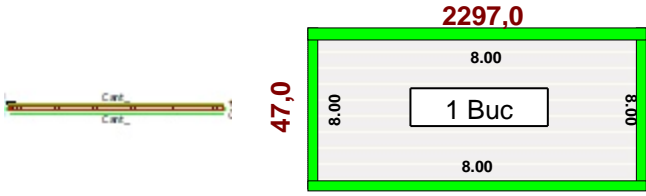

Filler st
Lateral ST
Notes:

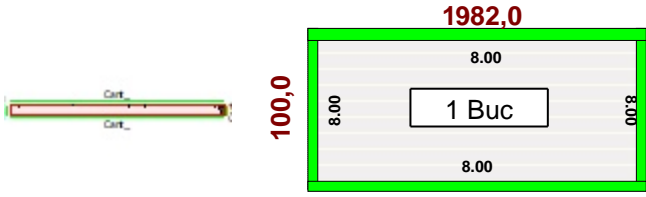

CNC1: 
10000000308

Front dt
Front_dreapta
Notes:

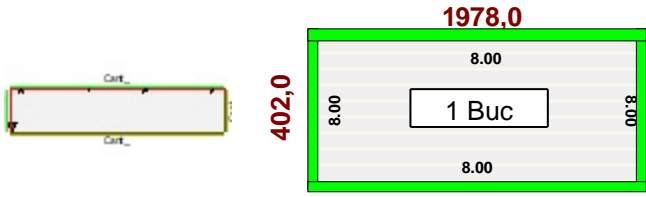

CNC1: 
10000000322

Front st
front_stanga
Notes:

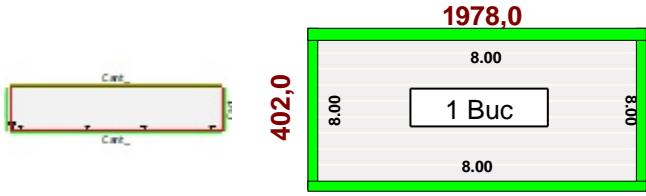

CNC1: 
10000000323

Cornisa
Lateral ST
Notes:

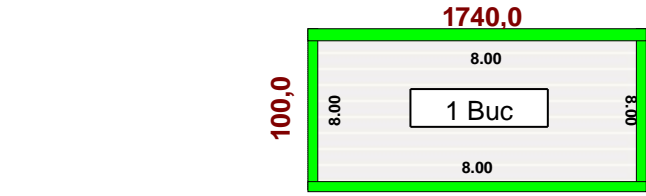

Front_dt

Front_dreapta

Notes:

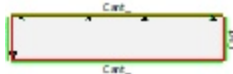

403,0

1978,0

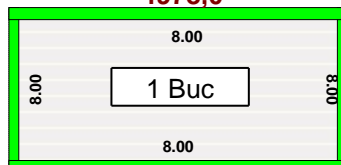

CNC1:



10000000337

Front_st

front_stanga

Notes:



403,0

1978,0

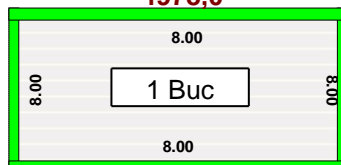

CNC1:



10000000338

Front_sertar

Front_legra

Notes:

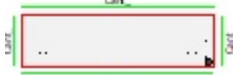

661,0

175,0

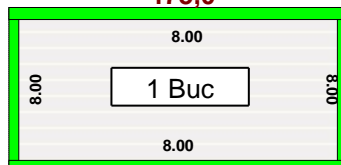

CNC1:



10000000339

Front_sertar

Front_legra

Notes:

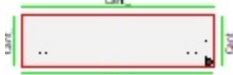

661,0

175,0

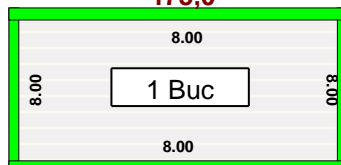

CNC1:



10000000344

Front_sertar

Front_legra

Notes:



661,0

175,0

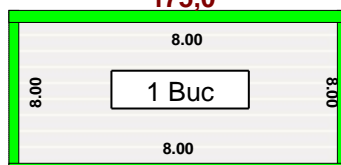

CNC1:



10000000349

Front_sertar

Front_legra

Notes:



661,0

175,0

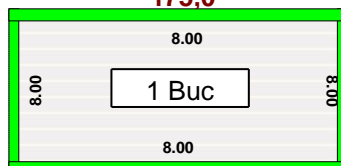

CNC1:



10000000354

Filler

Filler_dr

Notes:



100,0

1978,0

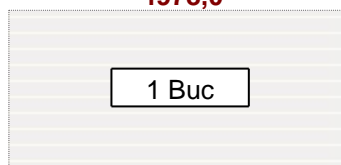

CNC1:



10000000360

Plinta

Laterală_ST

Notes:



1740,0

95,0

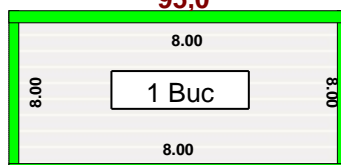

CNC1:



10000000361

Material:	Y352_FS15_18	Code:	FKY352_FS15_18	Thickness	18 mm
------------------	---------------------	--------------	-----------------------	------------------	--------------

TV Unit
Polita_2
Notes:

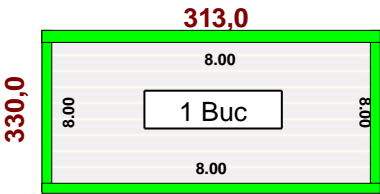
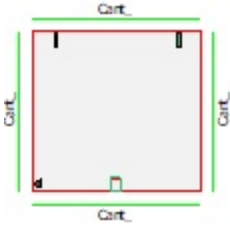

CNC1: 
110000000053

TV Unit
Polita_6
Notes:

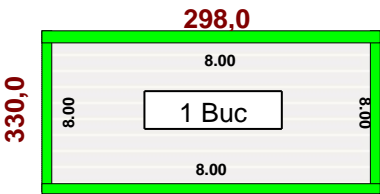
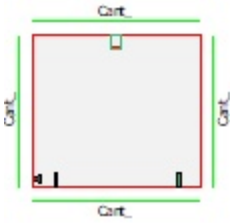

CNC1: 
110000000058

TV Unit
Polita_4
Notes:

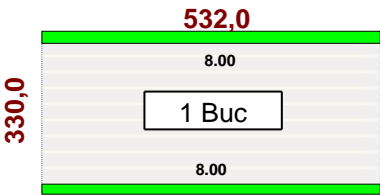
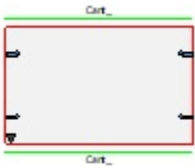

TV Unit
Polita_5
Notes:

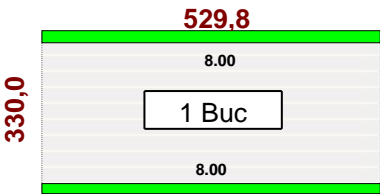

Material:	Y200_FS02_18	Code:	FKY200_FS02_18	Thickness	18 mm
------------------	---------------------	--------------	-----------------------	------------------	--------------

TV Unit
Rama_down
Notes:

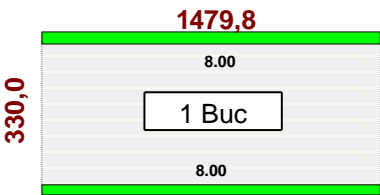

CNC1: 
110000000059

TV Unit
Rama_up
Notes:

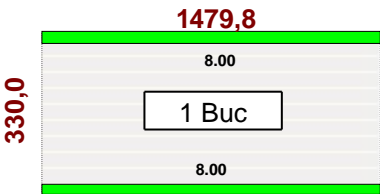

TV Unit
Rama_st
Notes:

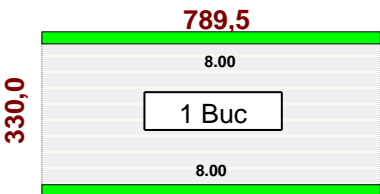

TV_Unit

Rama_dr

Notes:

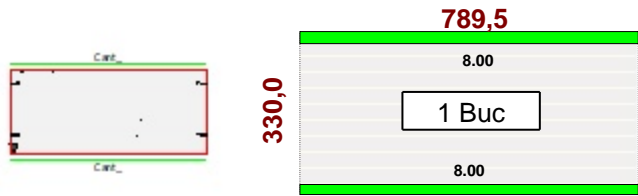

TV Unit

Spate_TV

Notes:

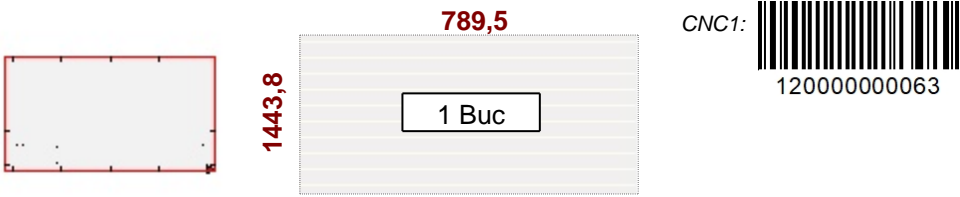

Soclu

Suport

Notes:

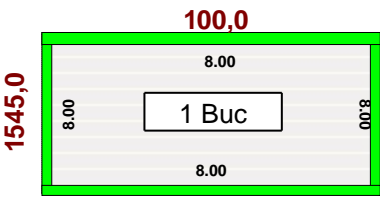

Material:	Y116_FS01_16	Code:	FKY116_FS01_16	Thickness	16 mm
-----------	--------------	-------	----------------	-----------	-------

Tandem

fund_sertar

Notes:

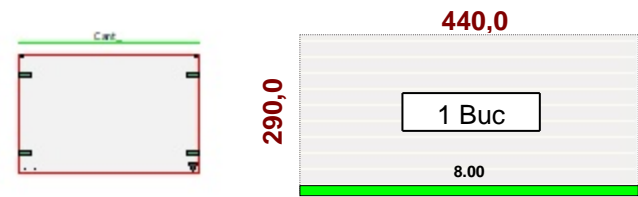

Tandem

Is_st

Notes:

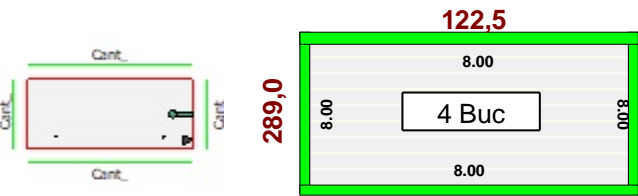

Tandem

Is_dt

Notes:

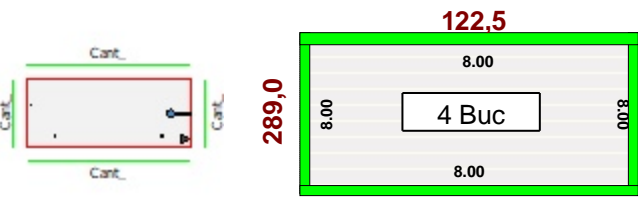

Tandem

spate_sertar

Notes:

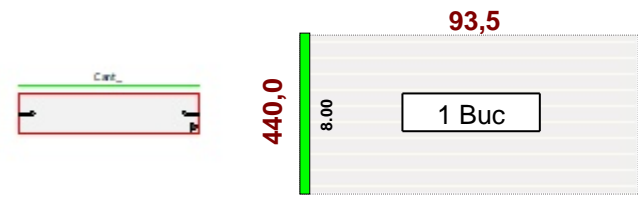

Tandem
fund_sertar
Notes:

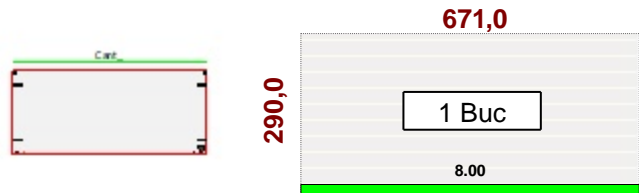

Tandem
spate_sertar
Notes:

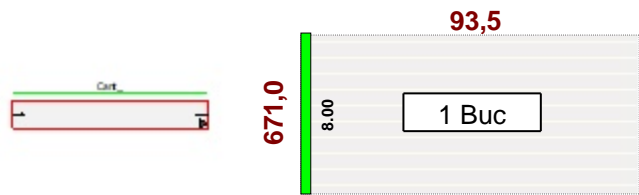

Tandem
fund_sertar
Notes:

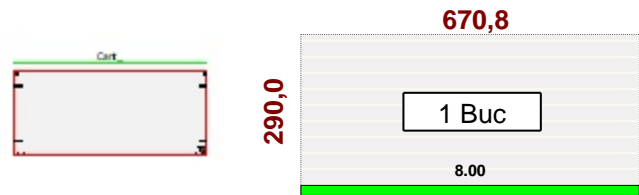

Tandem
spate_sertar
Notes:

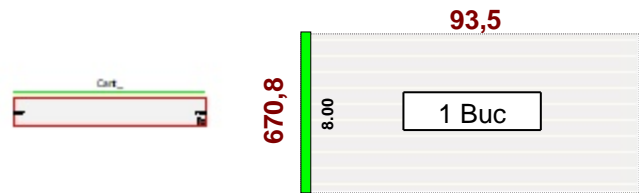

Tandem
fund_sertar
Notes:

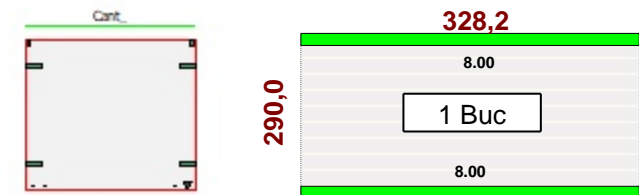

Tandem
spate_sertar
Notes:

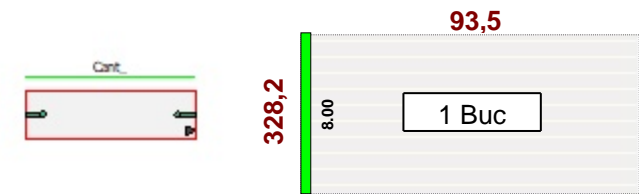

Tandem
fund_sertar
Notes:

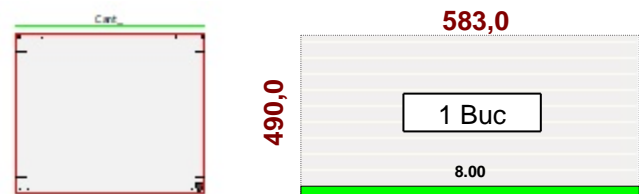

Tandem
ls_st
Notes:

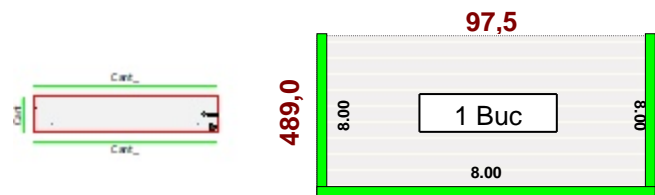

Tandem

ls_dt

Notes:

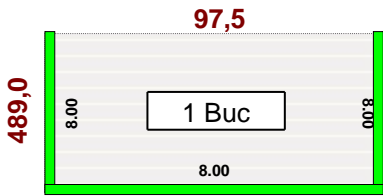

Tandem

spate_sertar

Notes:

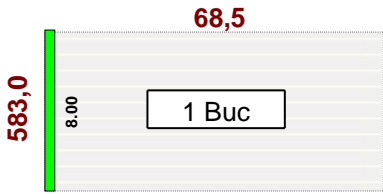
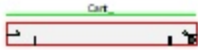

Tandem

fund_sertar

Notes:

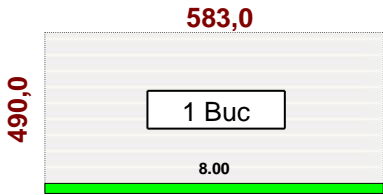
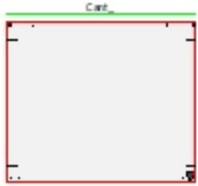

Tandem

ls_st

Notes:

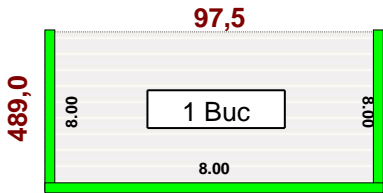

Tandem

ls_dt

Notes:

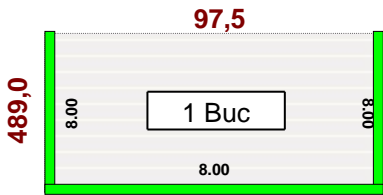
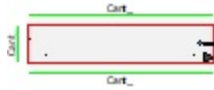

Tandem

spate_sertar

Notes:

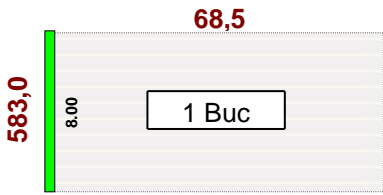
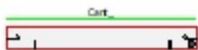

Tandem

fund_sertar

Notes:

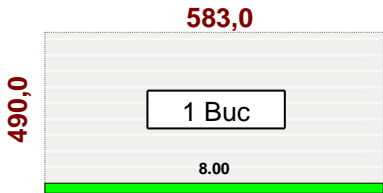
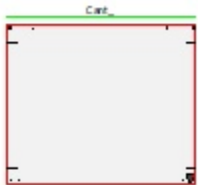

Tandem

ls_st

Notes:

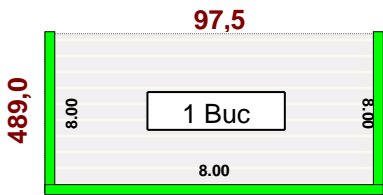

Tandem

ls_dt

Notes:

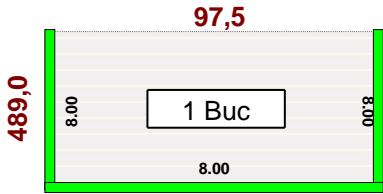

Tandem

spate_sertar

Notes:

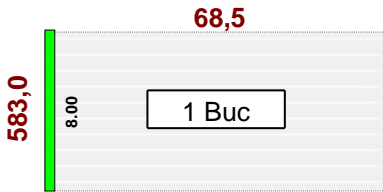
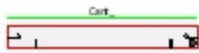

Tandem

fund_sertar

Notes:

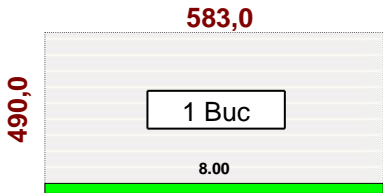
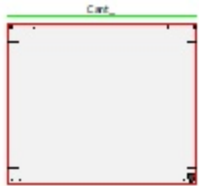

Tandem

ls_st

Notes:

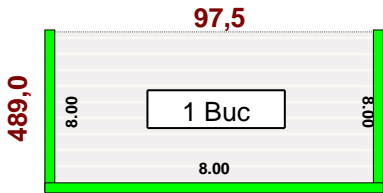

Tandem

ls_dt

Notes:

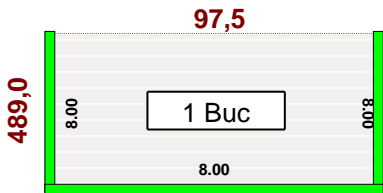
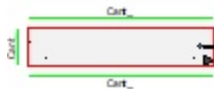

Tandem

spate_sertar

Notes:

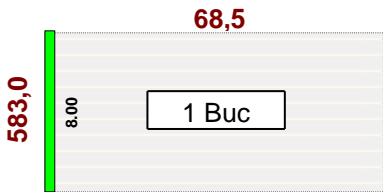
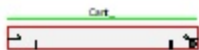

Material:	Y121_FS02_18	Code:	FKY121_FS02_18	Thickness	18 mm
-----------	--------------	-------	----------------	-----------	-------

Filler ST

Suport

Notes:

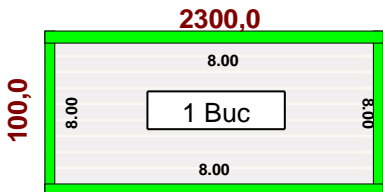

D1
Lateral_ST
Notes:

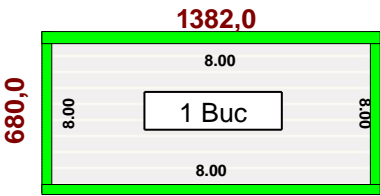
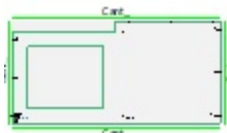

D1
Lateral_DR
Notes:

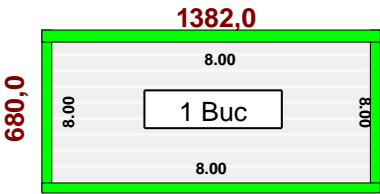

D1
Fund
Notes:

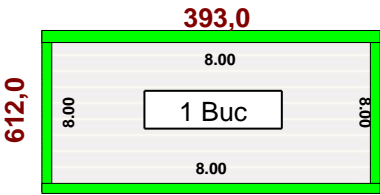
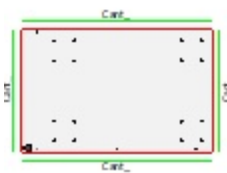

D1
Capac
Notes:

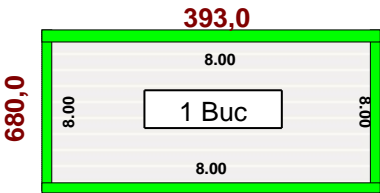
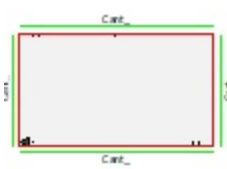

D1
Polita_1
Notes:

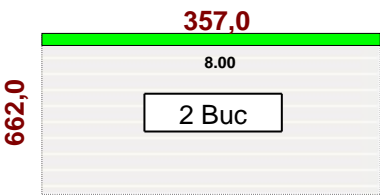
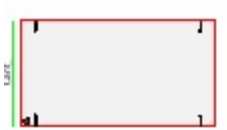

D1
Polita_3
Notes:

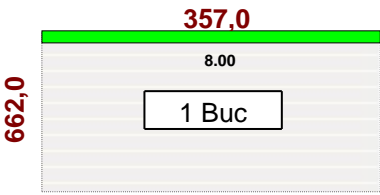

D1
Sp_gros
Notes:

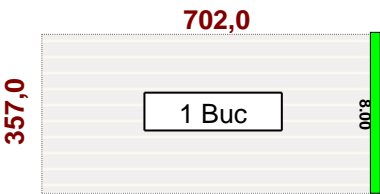
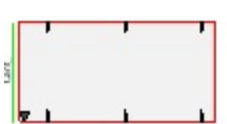

D1
Capac_up
Notes:

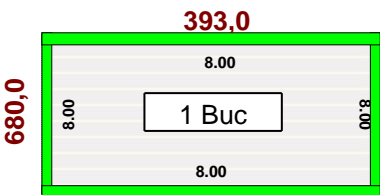

D1
Lateral ST_UP
Notes:

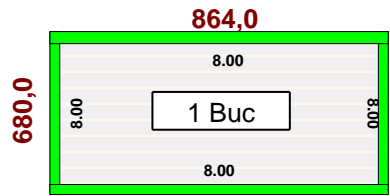
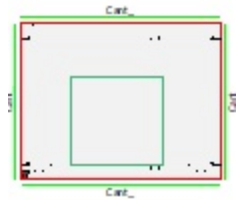

D1
Lateral DR1
Notes:

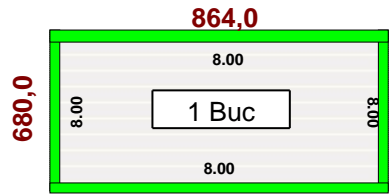
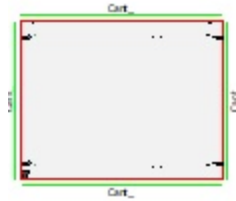

D1
Sp_gros1
Notes:

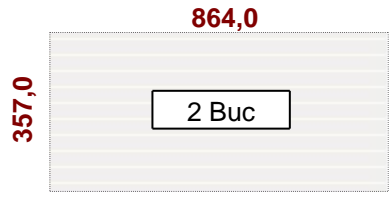
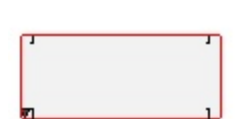

D3
Lateral ST
Notes:

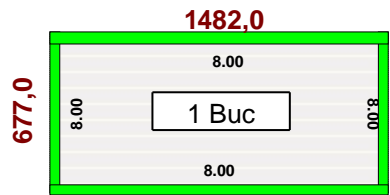
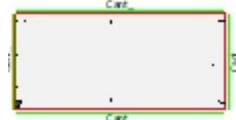

D3
Lateral DR
Notes:

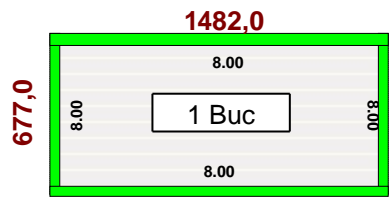

D3
Fund
Notes:

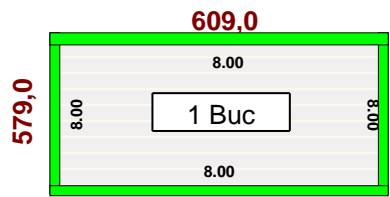
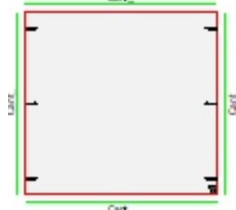

D3
Capac
Notes:

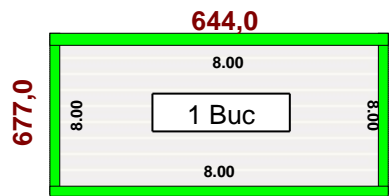

D3
Lateral DR_DN
Notes:

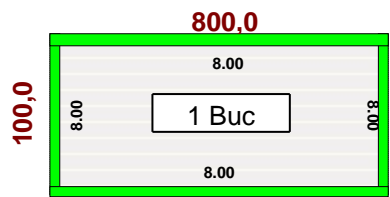

D2
Lateral_ST
Notes:

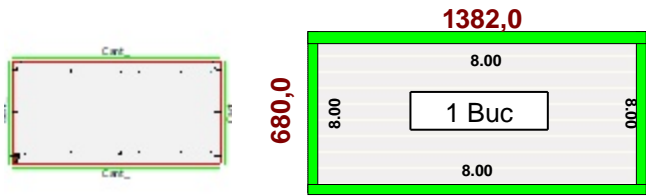

D2
Lateral_DR
Notes:

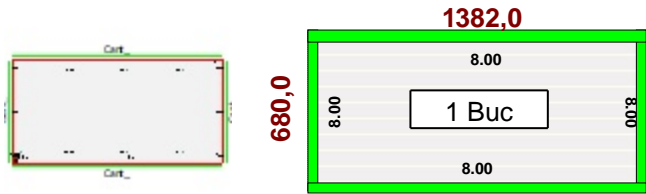

D2
Fund
Notes:

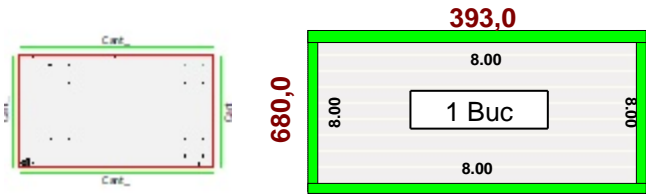

D2
Capac
Notes:

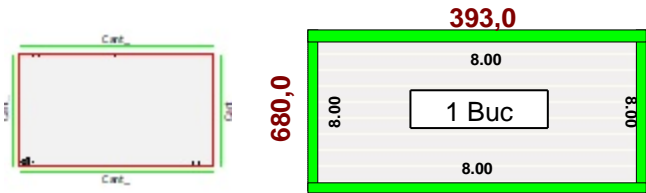

D2
Polita_1
Notes:

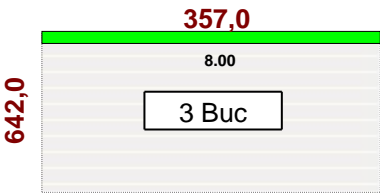

D2
Polita_4
Notes:

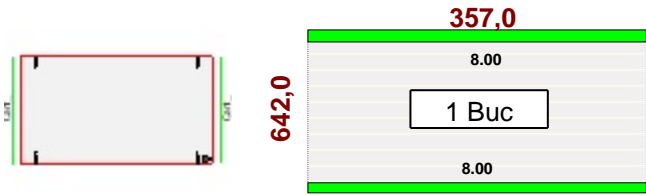

D2
Polita_5
Notes:

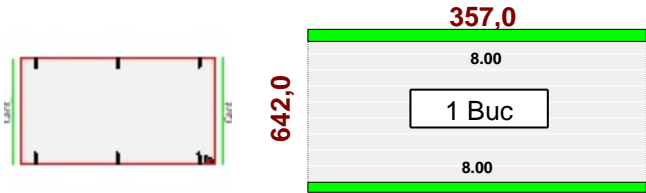

D2
Sp_gros
Notes:

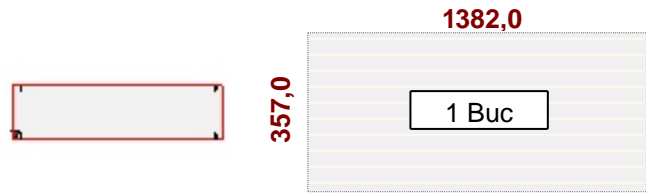

D2
Capac_up
Notes:

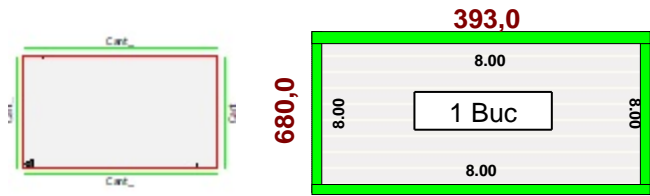

D2
Lateral ST_UP
Notes:

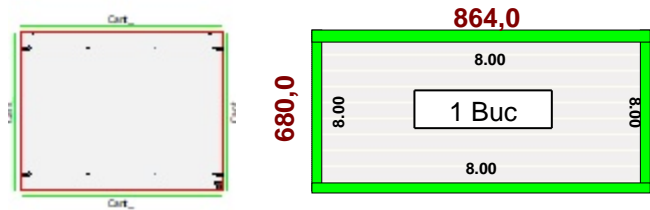

D2
Lateral DR1
Notes:

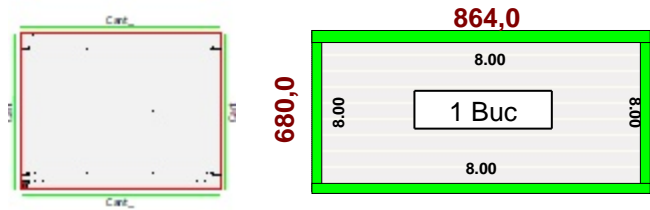

Filler dr
Suport
Notes:

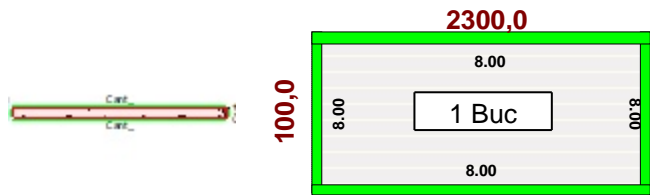

D1
Lateral ST
Notes:

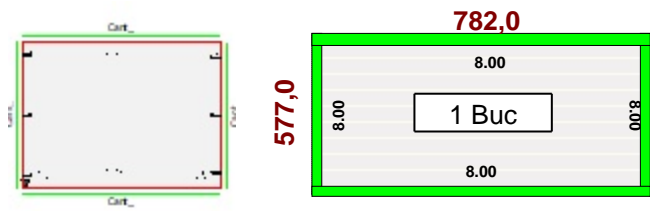

CNC1: 
10000000310

D1
Lateral DR
Notes:

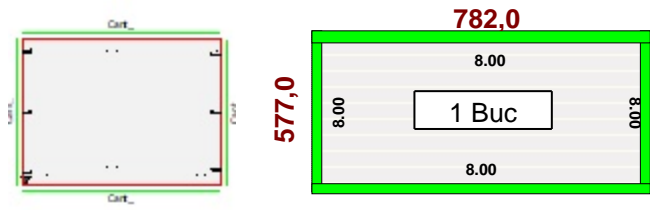

CNC1: 
10000000311

D1
Fund
Notes:

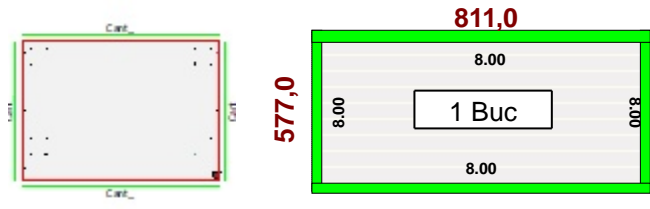

CNC1: 
10000000312

D1
Capac
Notes:

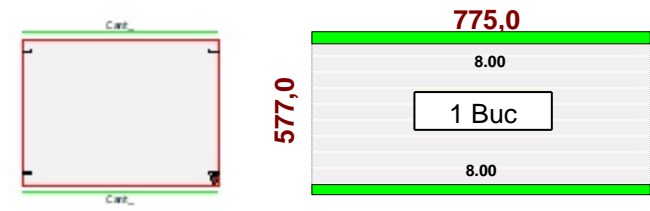

CNC1: 
10000000313

D1
Polita_1
Notes:

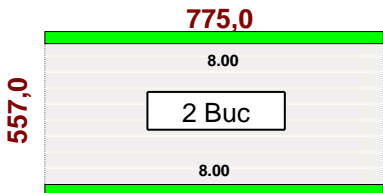

D1
Polita_3
Notes:

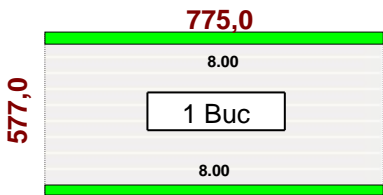
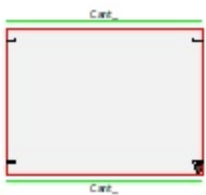

CNC1: 
10000000315

D1
Lateral ST_up
Notes:

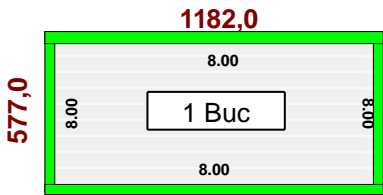
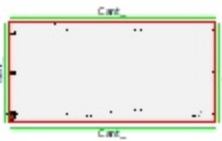

CNC1: 
10000000317

D1
Lateral DR_up
Notes:

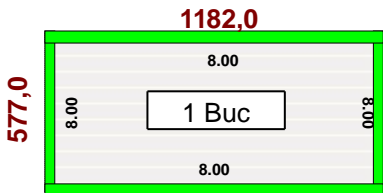
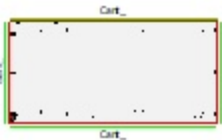

CNC1: 
10000000318

D1
Capac_up
Notes:

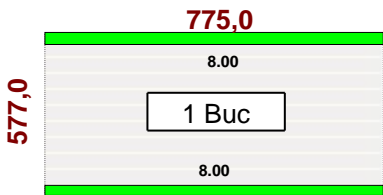
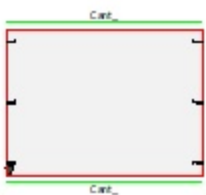

CNC1: 
10000000320

D1
legatura_up
Notes:

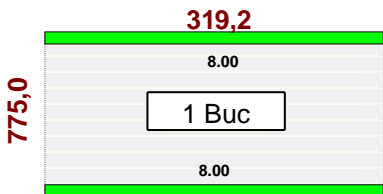
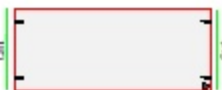

CNC1: 
10000000321

D2
Lateral ST
Notes:

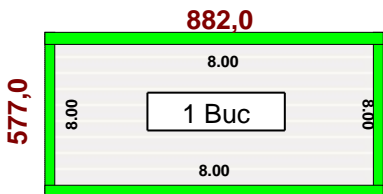
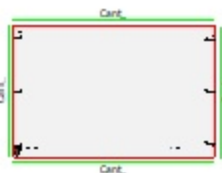

CNC1: 
10000000326

D2
Lateral DR
Notes:

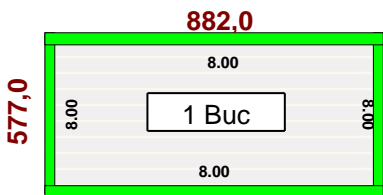

CNC1: 
10000000327

D2

Fund

Notes:

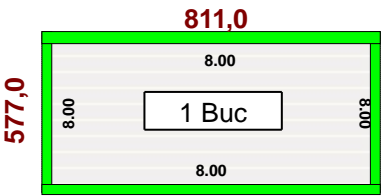
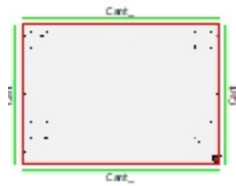

D2

Capac

Notes:

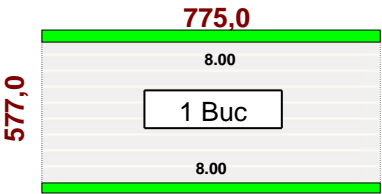
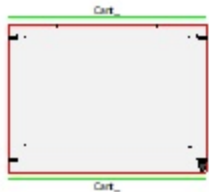

D2

Lateral ST_up

Notes:

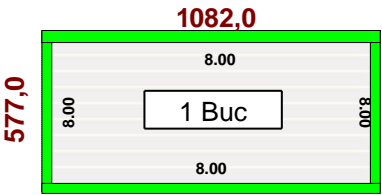

D2

Lateral DR_up

Notes:

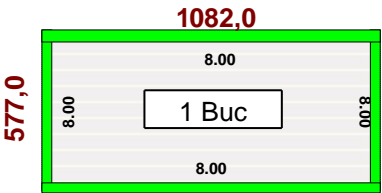

D2

Capac_up

Notes:

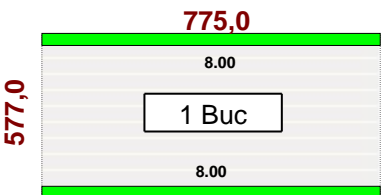
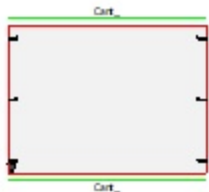

D2

legatura_up

Notes:

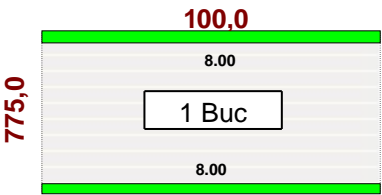

D2

Lateral DR_srt

Notes:

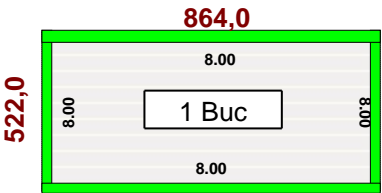
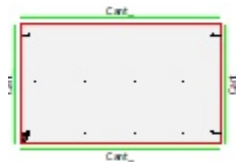

D2

Lateral ST_srt

Notes:

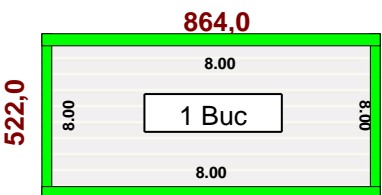
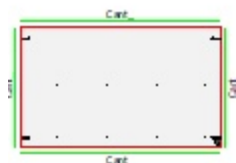

Filler_dr
Lateral DT
Notes:

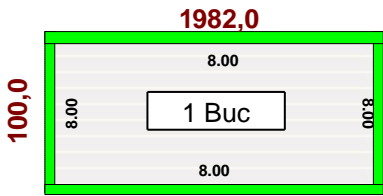
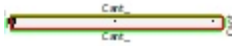

Material:	PFL_Alb_	Code:	PFL_Alb_3	Thickness	3 mm

D3
Spate
Notes:

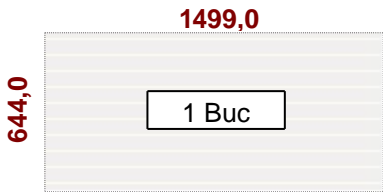

D1
Spate
Notes:

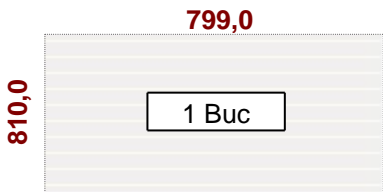

D1
Spate_up
Notes:

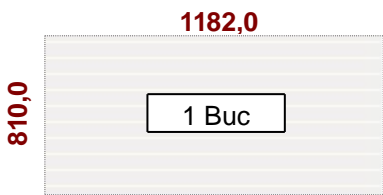

D2
Spate
Notes:

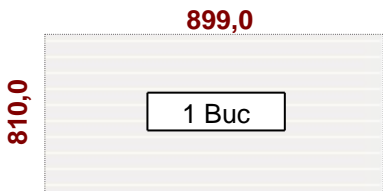

D2
Spate_up
Notes:

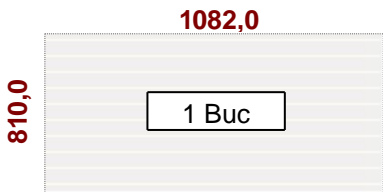

Material:	Y642_FS26_18	Code:	FKY642_FS26_18	Thickness	18 mm

Riflaj
element1
Notes:

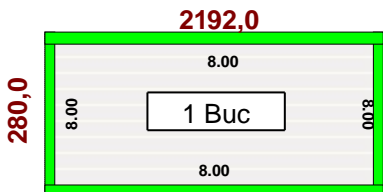
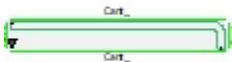

Riflaj
Baza1
Notes:

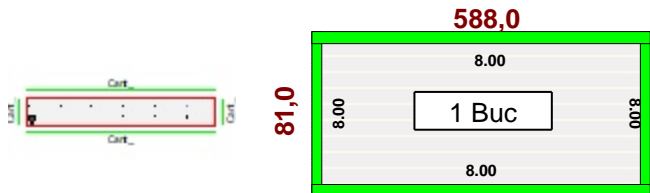

CNC1: 
10000000363

Riflaj
element2
Notes:

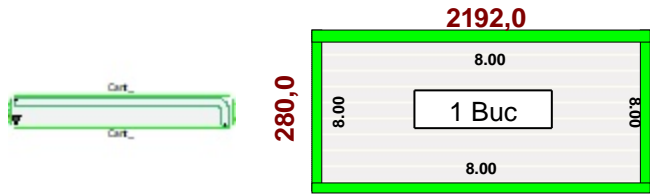

CNC1: 
10000000364

Riflaj
element3
Notes:

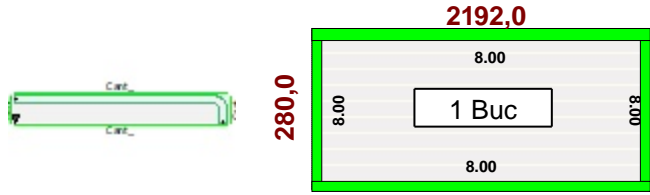

CNC1: 
10000000365

Riflaj
element4
Notes:

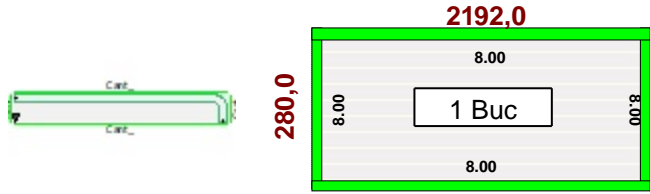

CNC1: 
10000000366

Riflaj
element5
Notes:

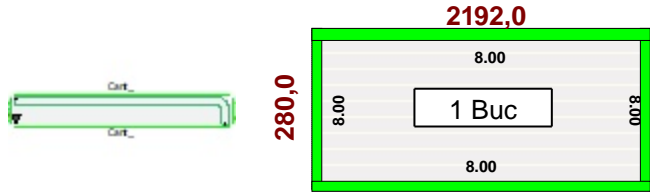

CNC1: 
10000000367

Riflaj
element6
Notes:

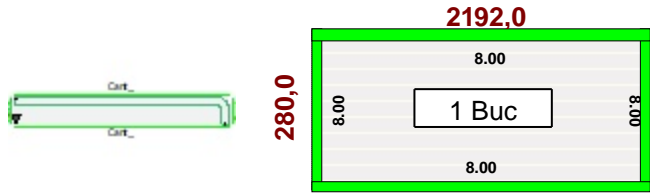

CNC1: 
10000000368

Riflaj
Suport
Notes:

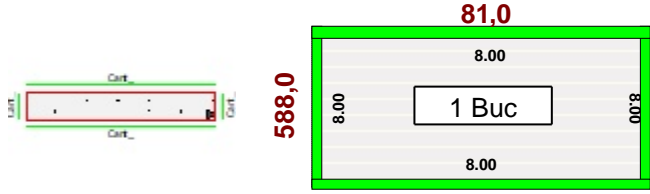

CNC1: 
10000000369

Riflaj
element1
Notes:

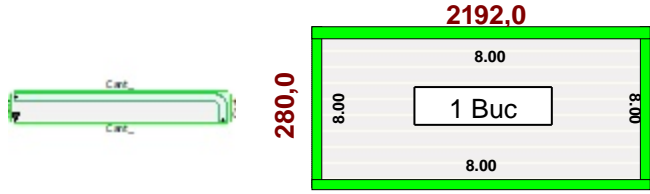

CNC1: 
10000000370

Riflaj
Baza1
Notes:

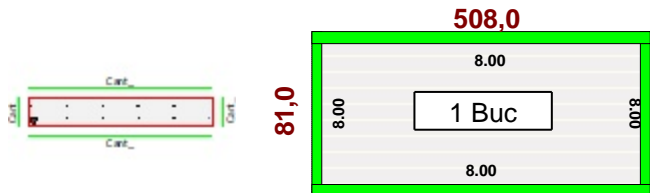

CNC1: 
10000000371

Riflaj
element2
Notes:

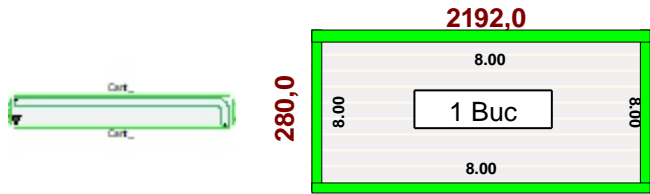

CNC1: 
10000000372

Riflaj
element3
Notes:

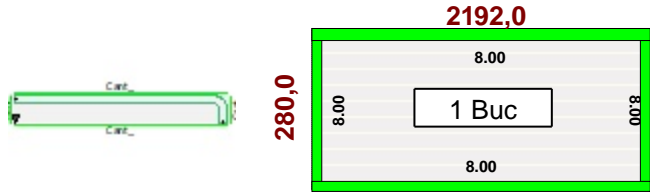

CNC1: 
10000000373

Riflaj
element4
Notes:

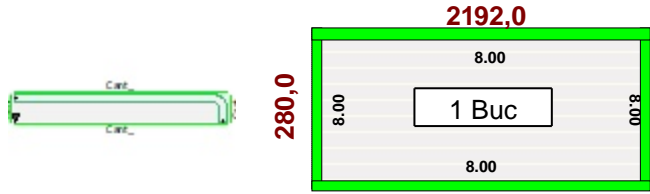

CNC1: 
10000000374

Riflaj
element5
Notes:

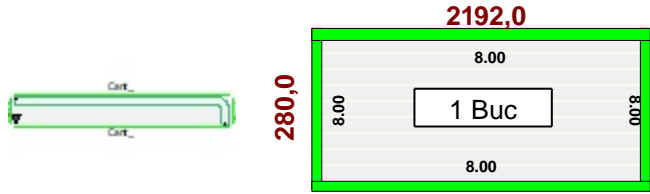

CNC1: 
10000000375

Riflaj
element6
Notes:

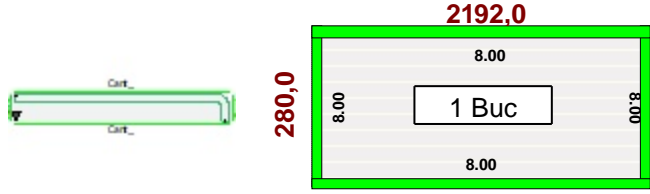

CNC1: 
10000000376

Riflaj
Suport
Notes:

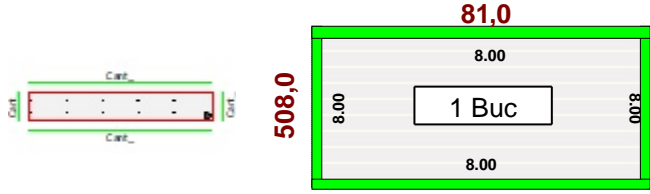

CNC1: 
10000000377