



PROIECT DRESSING

Explicatii tehnice

Insula

- Modul insula cu perna tapitata rabatabila: H 500 mm x L 700 mm x Ad 450 mm

A

Ansamblu corpuri A: H 2020 mm x L 3125 mm x Ad 210/350/600 mm

- Modul rama pentru depozitarea uscatorului de rufe: H 2020 mm x L 1009 mm x Ad 210mm
- Modul corp depozitare accesorii: H 2020 mm x L 1380 mm x Ad 350 mm
- Modul corp depozitare ski: H 2020 mm x L 736 mm x Ad 600 mm

C

Ansamblu corpuri C: H 2512 mm x L1434 x Ad 600mm

Modul polite, cu front de oglinda maro fumurie: H 2512 mm x L 461 mm x Ad 600 mm

Modul corp polite + zona umerase: H 2515 mm x L 923 mm x Ad 600mm

B-C

- Modul corp pe colt intermediar B-C: cu front de oglinda maro fumurie + spatiu depozitare saci de dormit

B

Ansamblu corpuri B: H 2512 mm x L1560 x Ad 600mm

- Modul polite, cu front de oglinda maro fumurie : H 2512 mm x L 503 mm x Ad 600 mm
- Modul corp polite + zona umerase: H 2515 mm x L 1007 mm x Ad 600mm

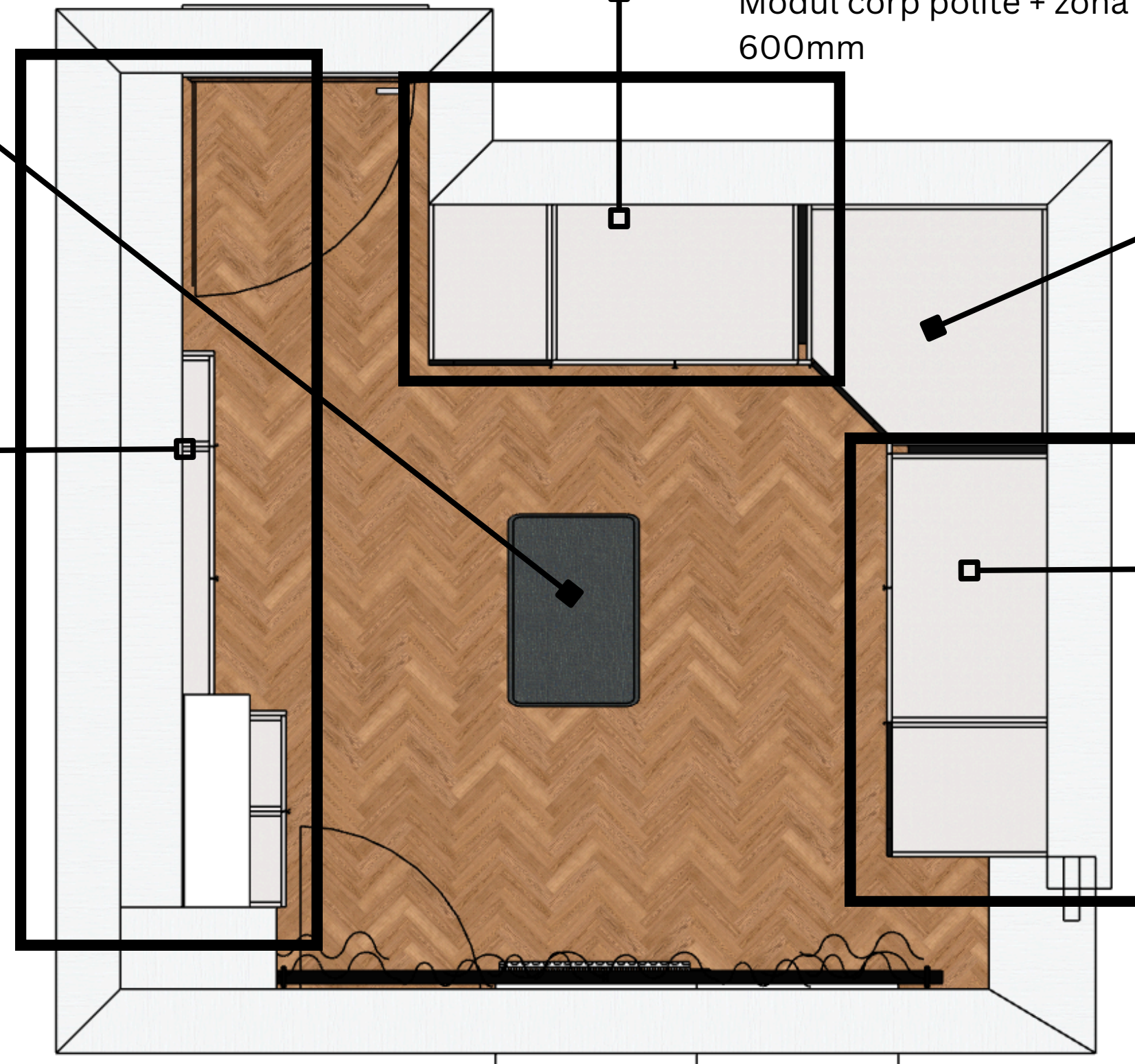

Plan dressing

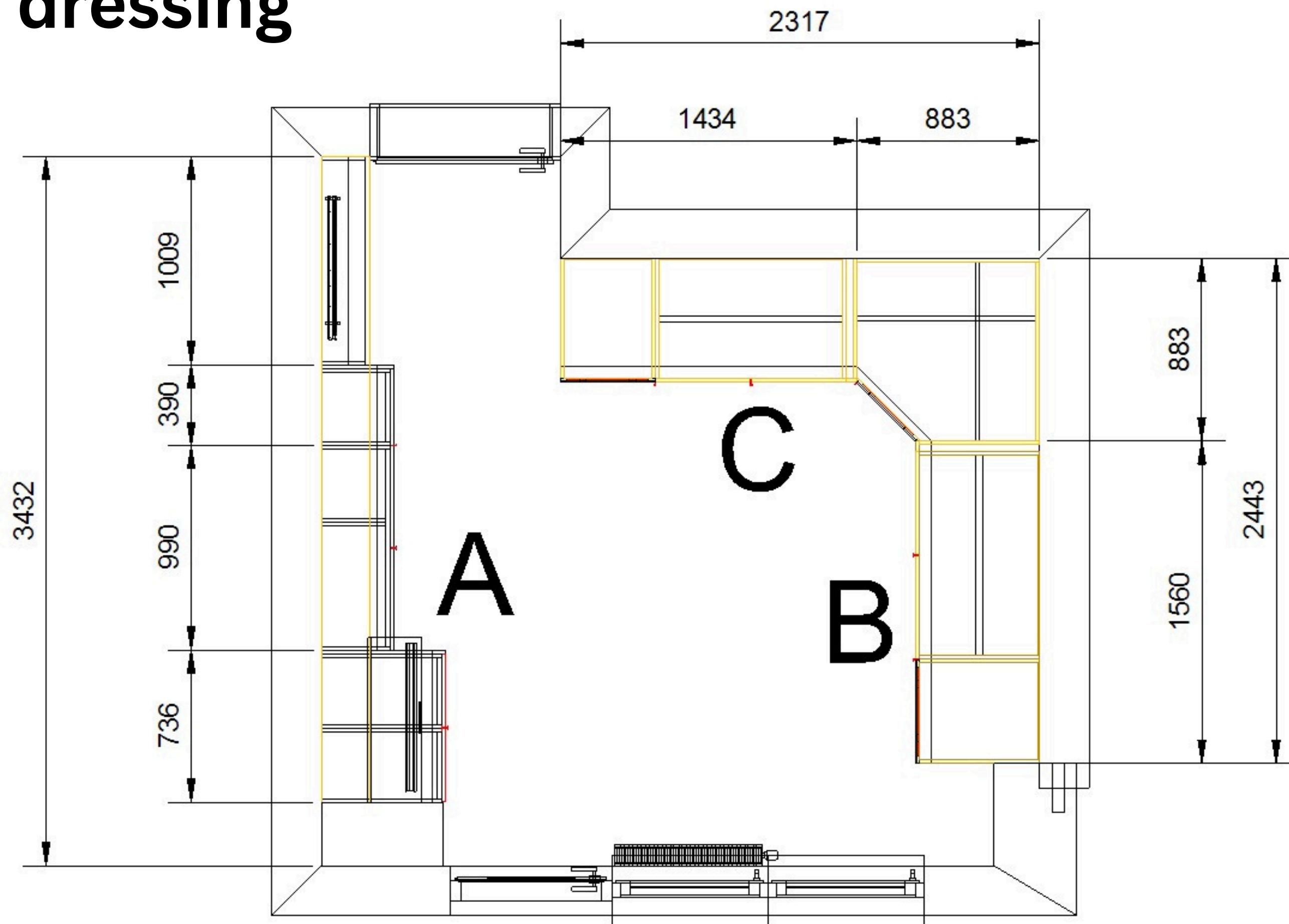

Ansamblu corpuri A

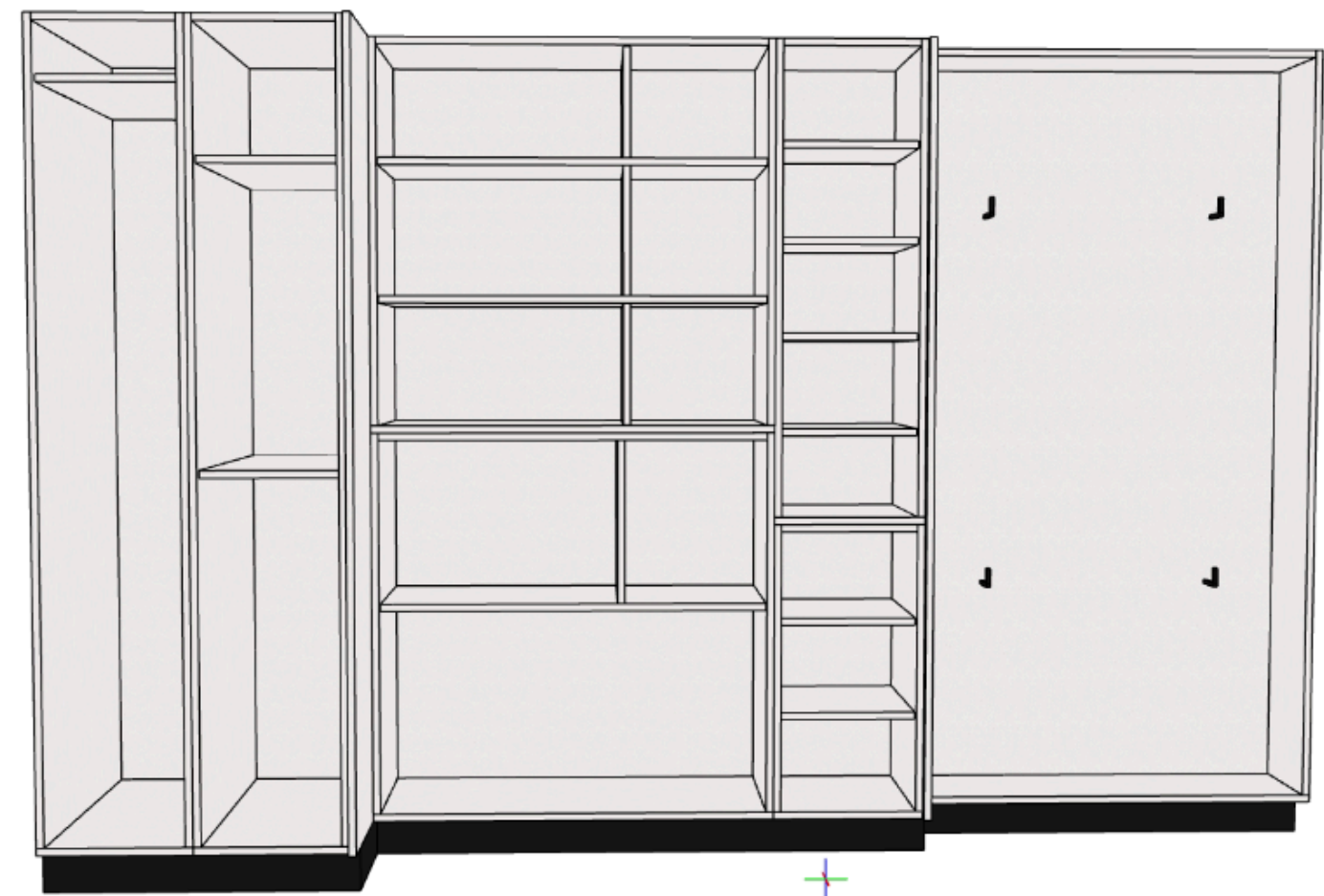
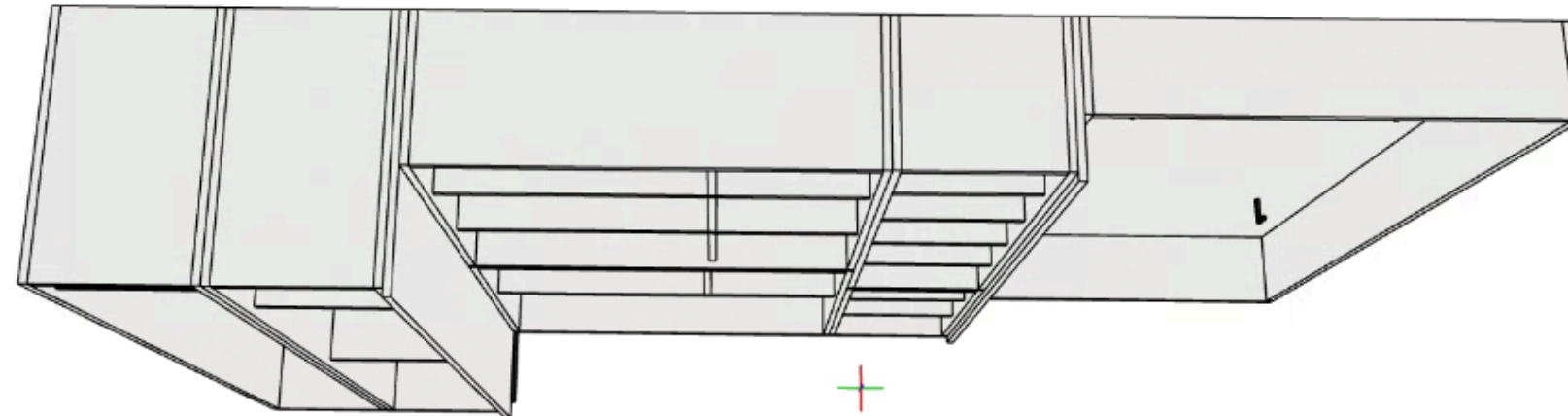

Ansamblu corpuri A:

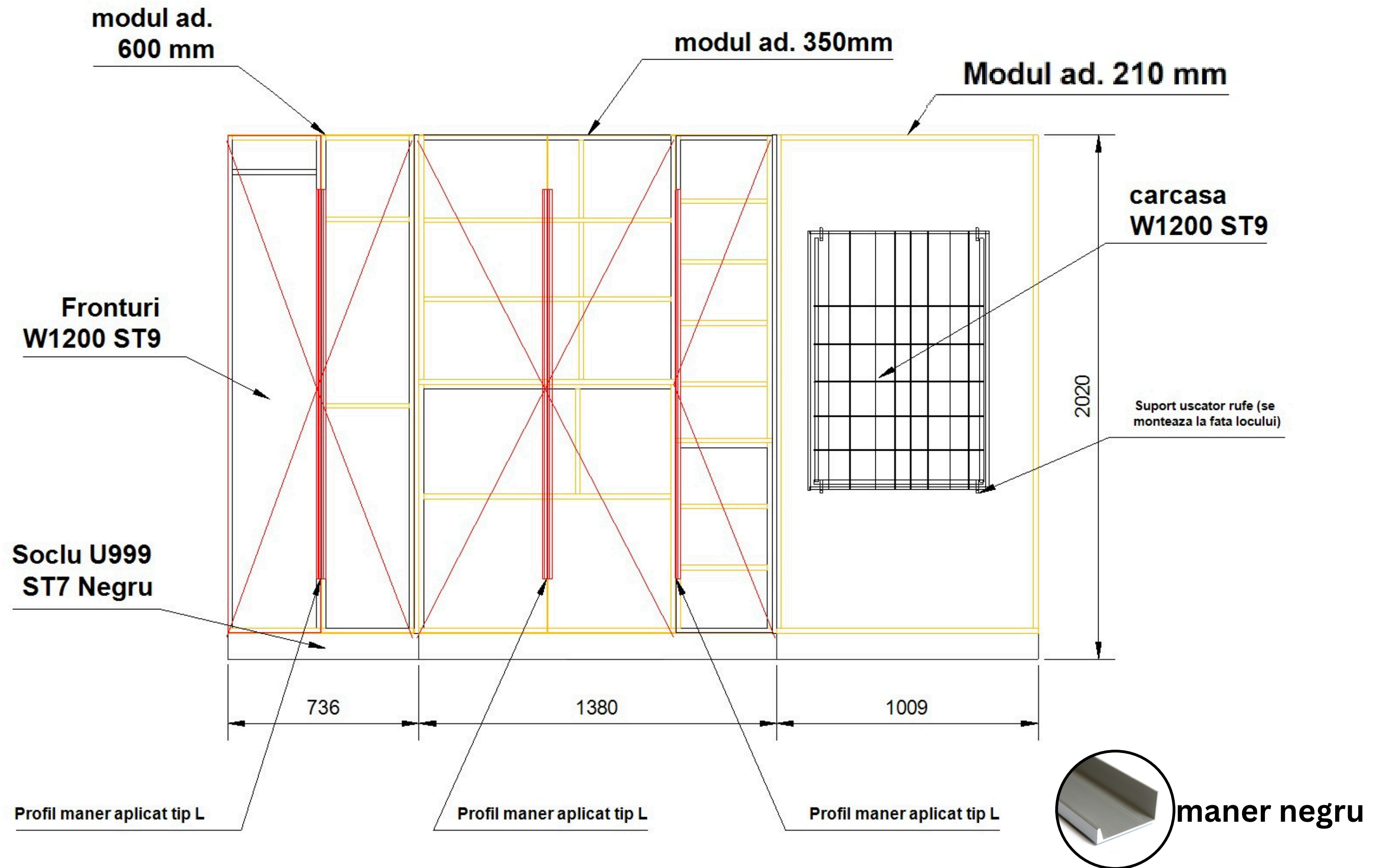

Ansamblu corpuri A:

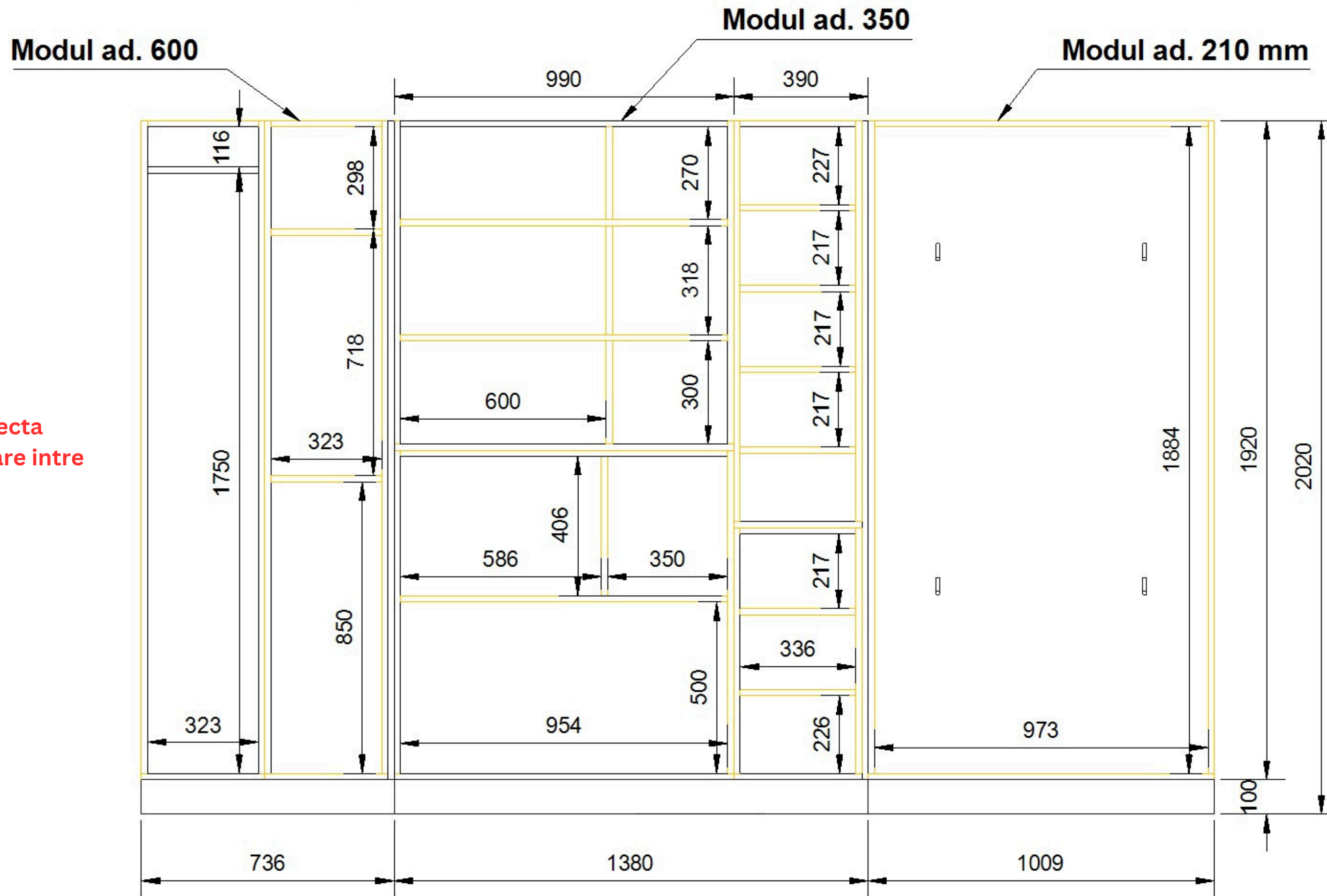

Rog a se respecta
cotele inerioare intre
polite!

Ansamblu corpuri B

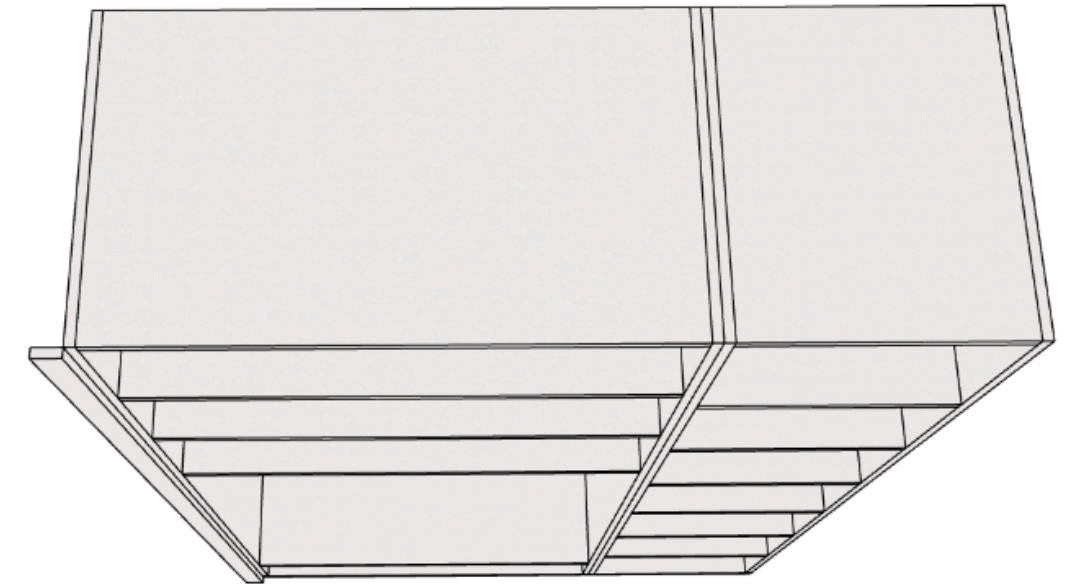
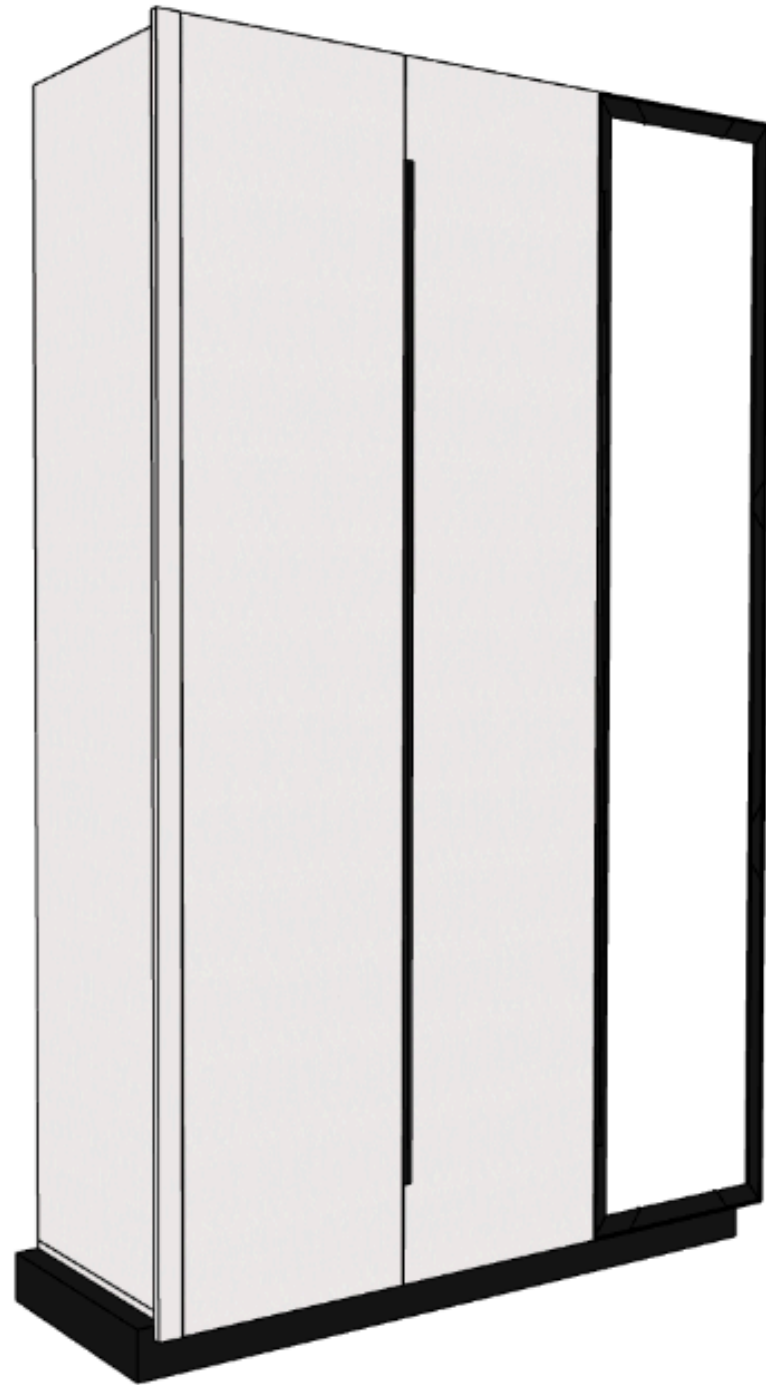

Ansamblu corpuri B:

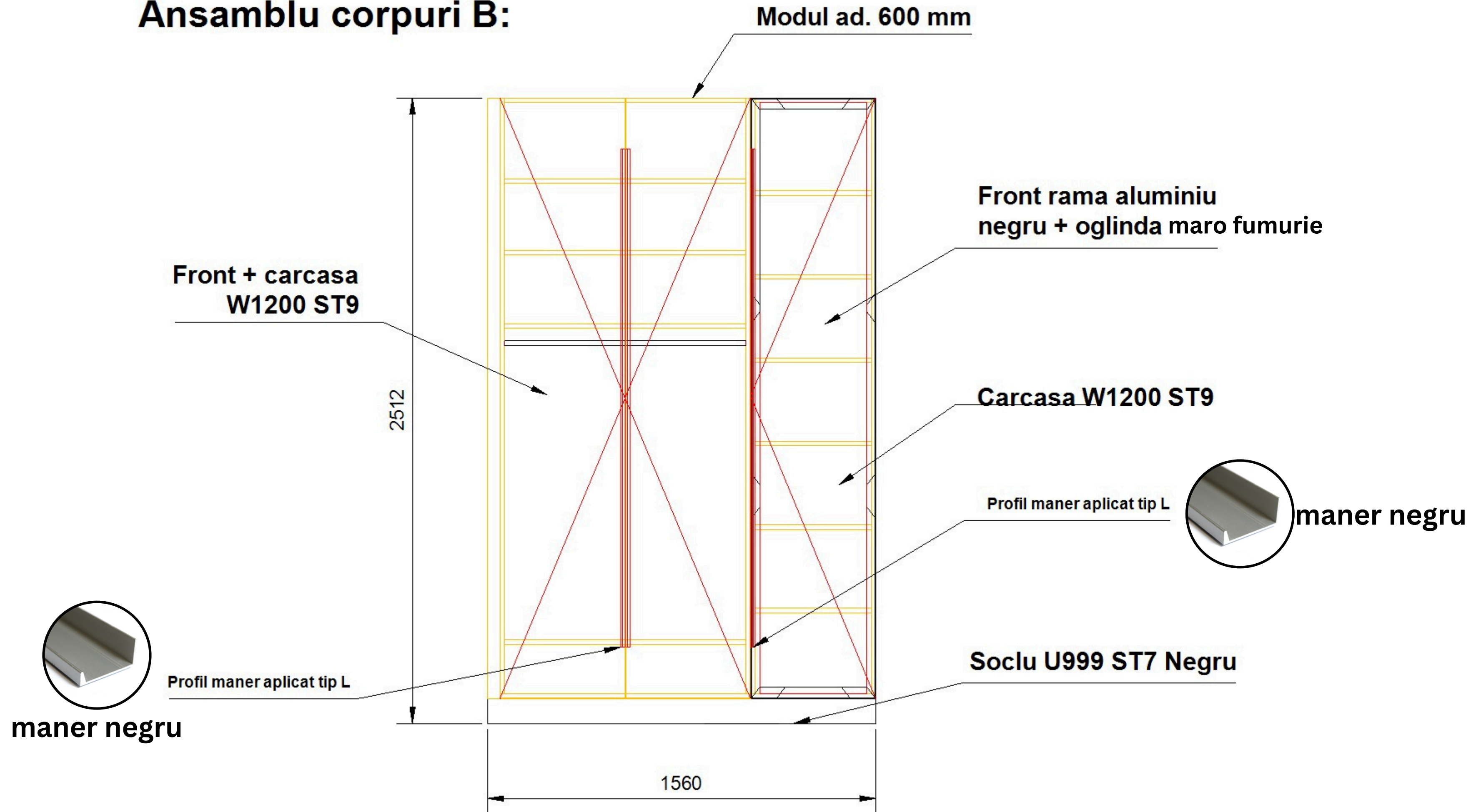

Ansamblu corpuri B:

Rog a se respecta
cotele inerioare intre
polite!

bara umerase

Modul ad. 600 mm

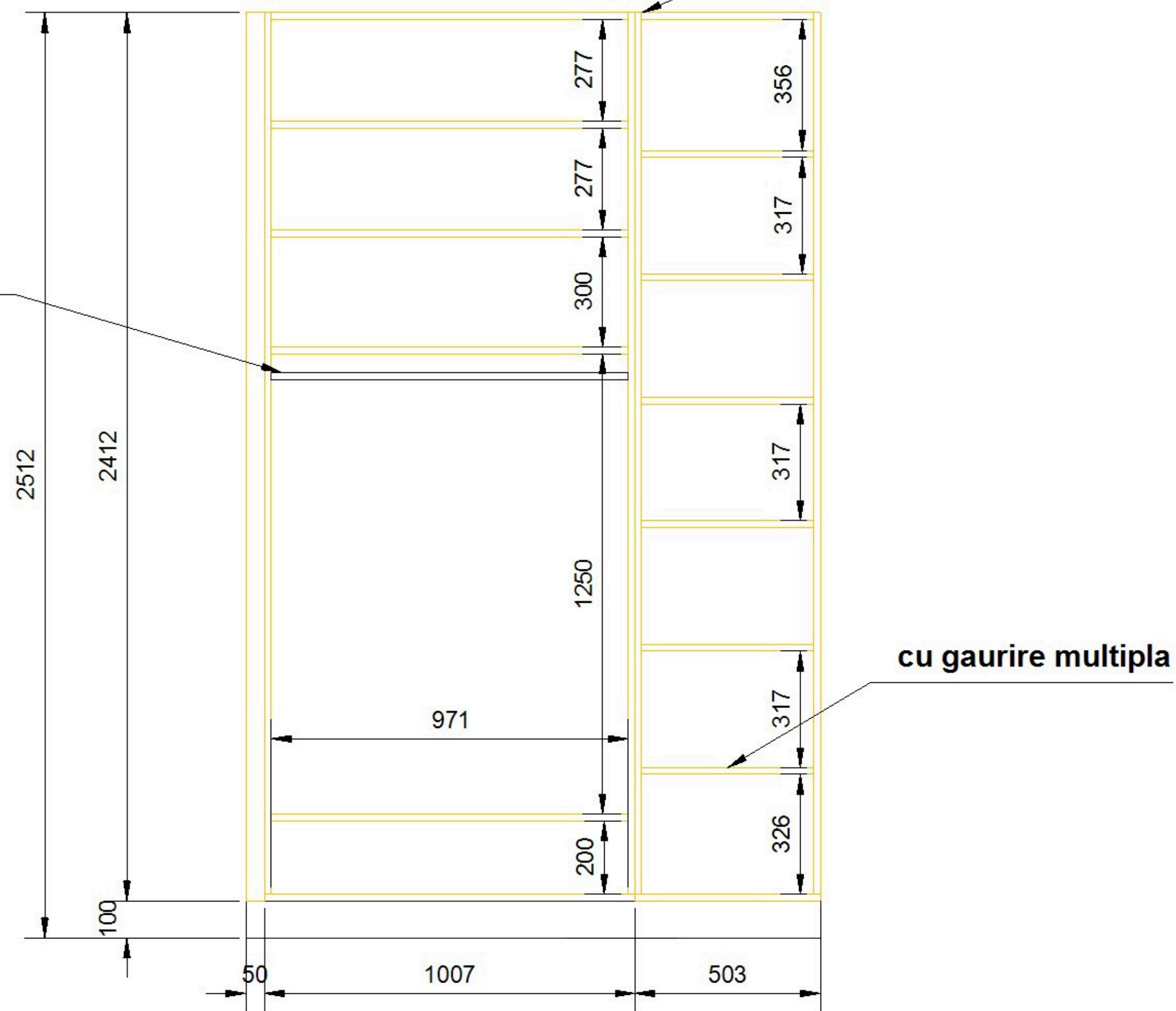

B-C

- Modul corp pe colt intermediar B-C: cu front de oglinda maro fumurie + spatiu depozitare saci de dormit

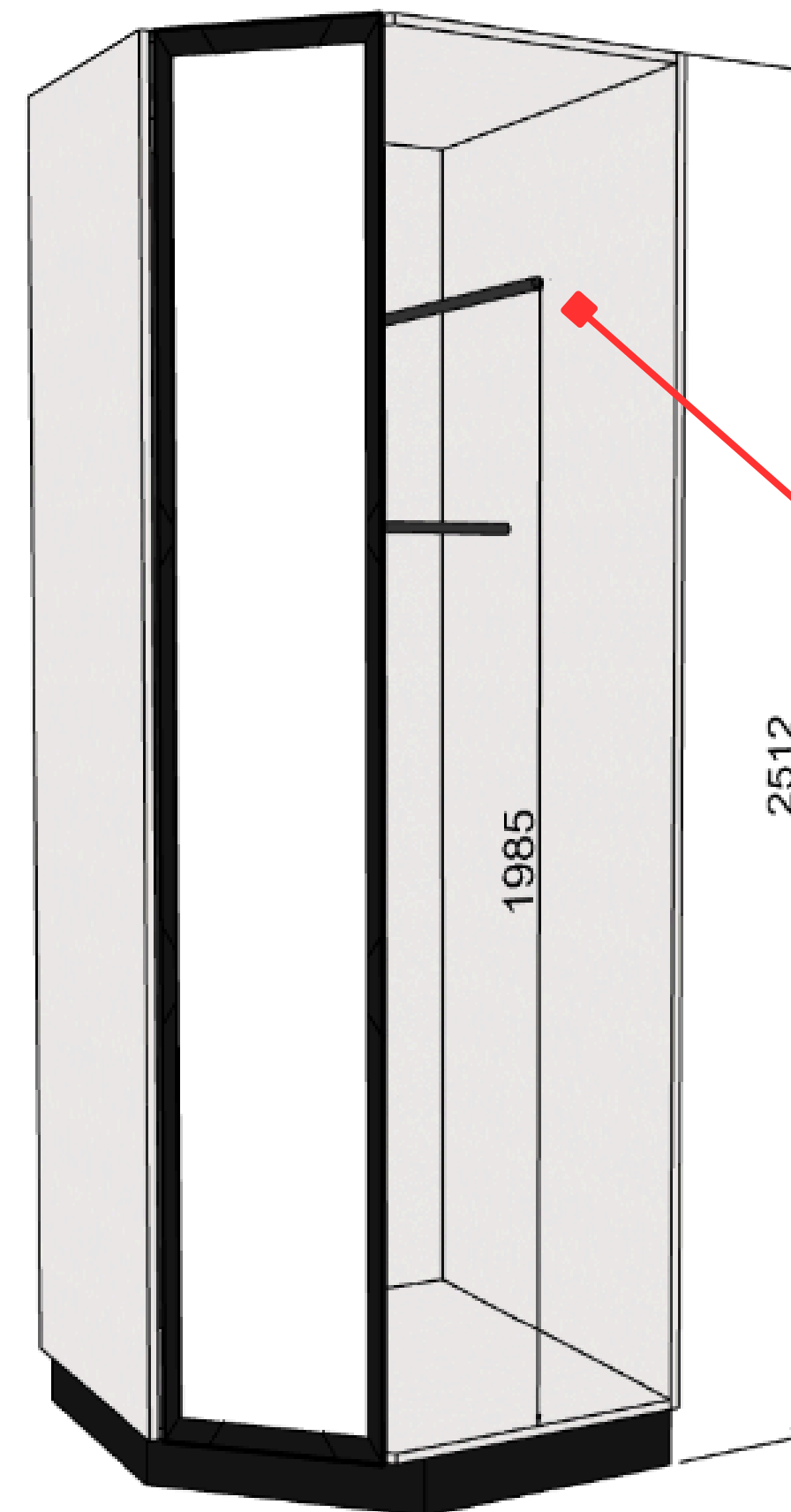

bara de umerase
se va folosi
pentru a depozita
verticla pe
umeras sacii de
dormit (acestia au
dimensiunea de
1700/1800mm H)

Ansamblu corpuri C

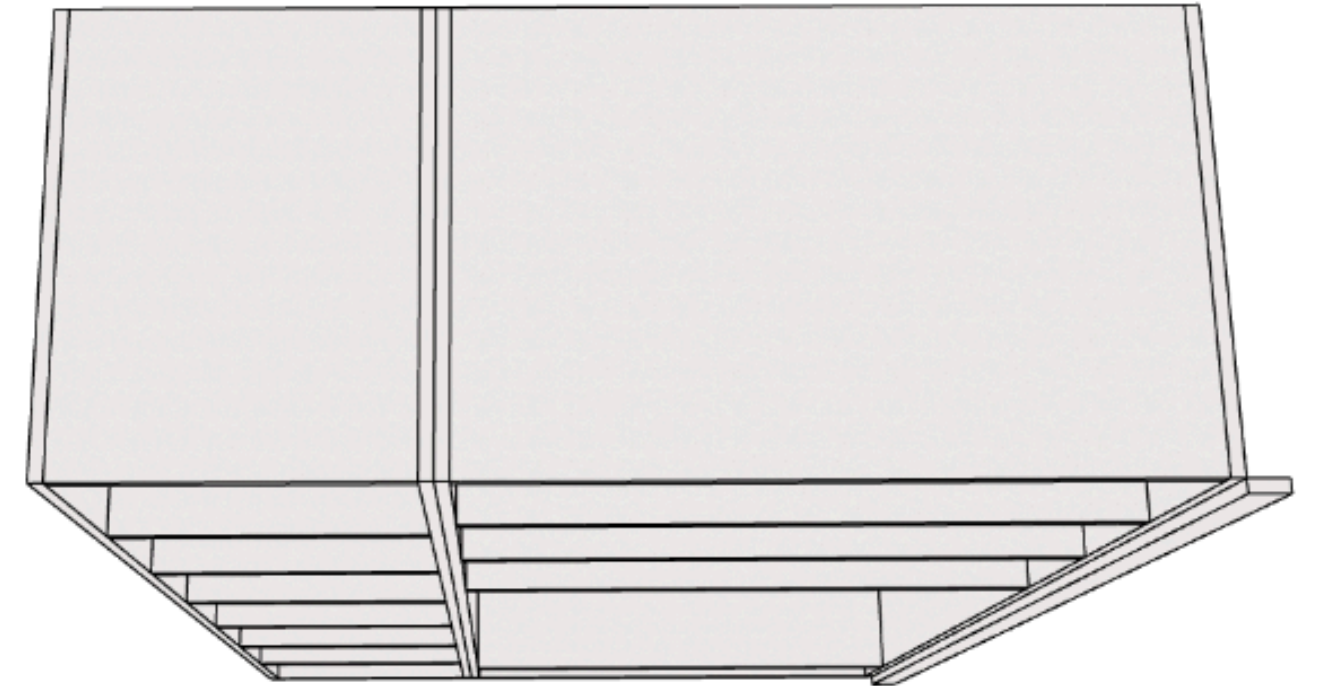
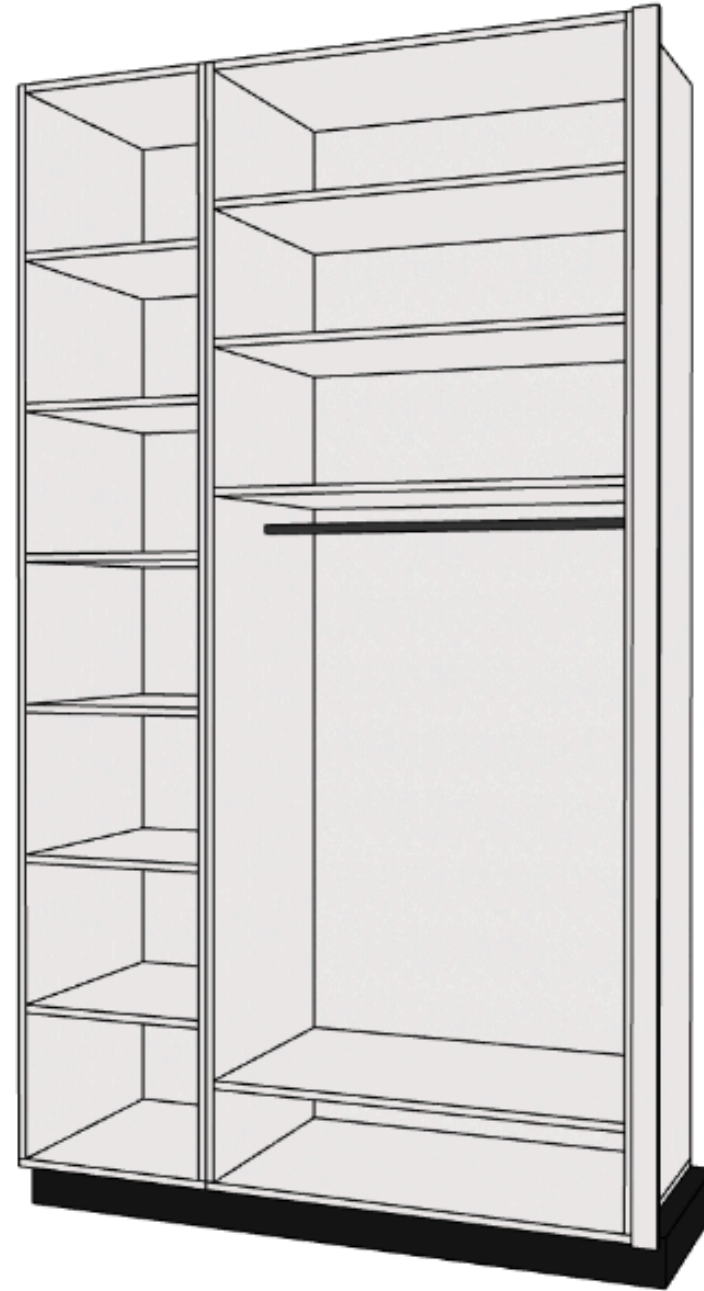

Ansamblu corpuri C:

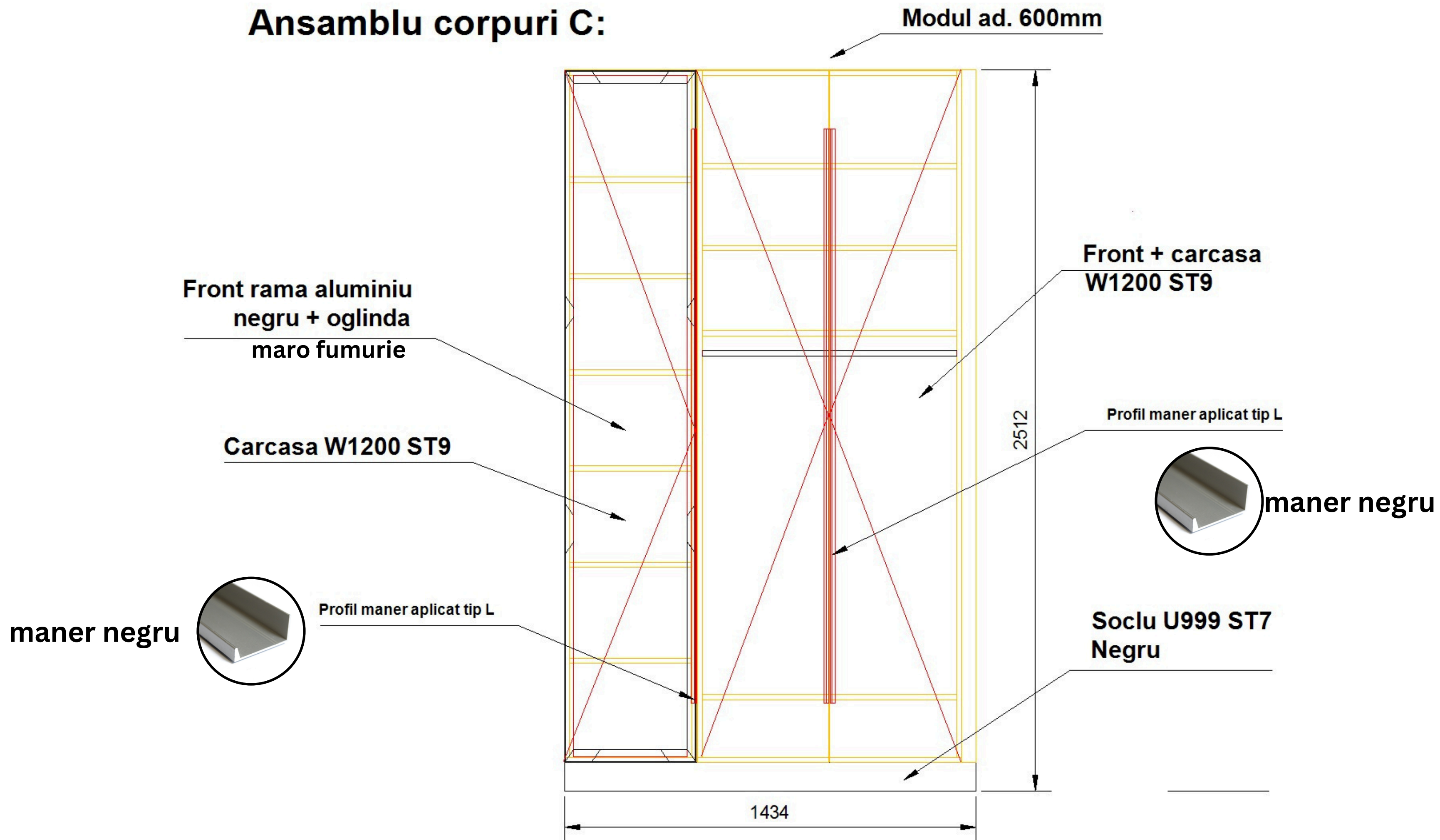

Ansamblu corpuri C:

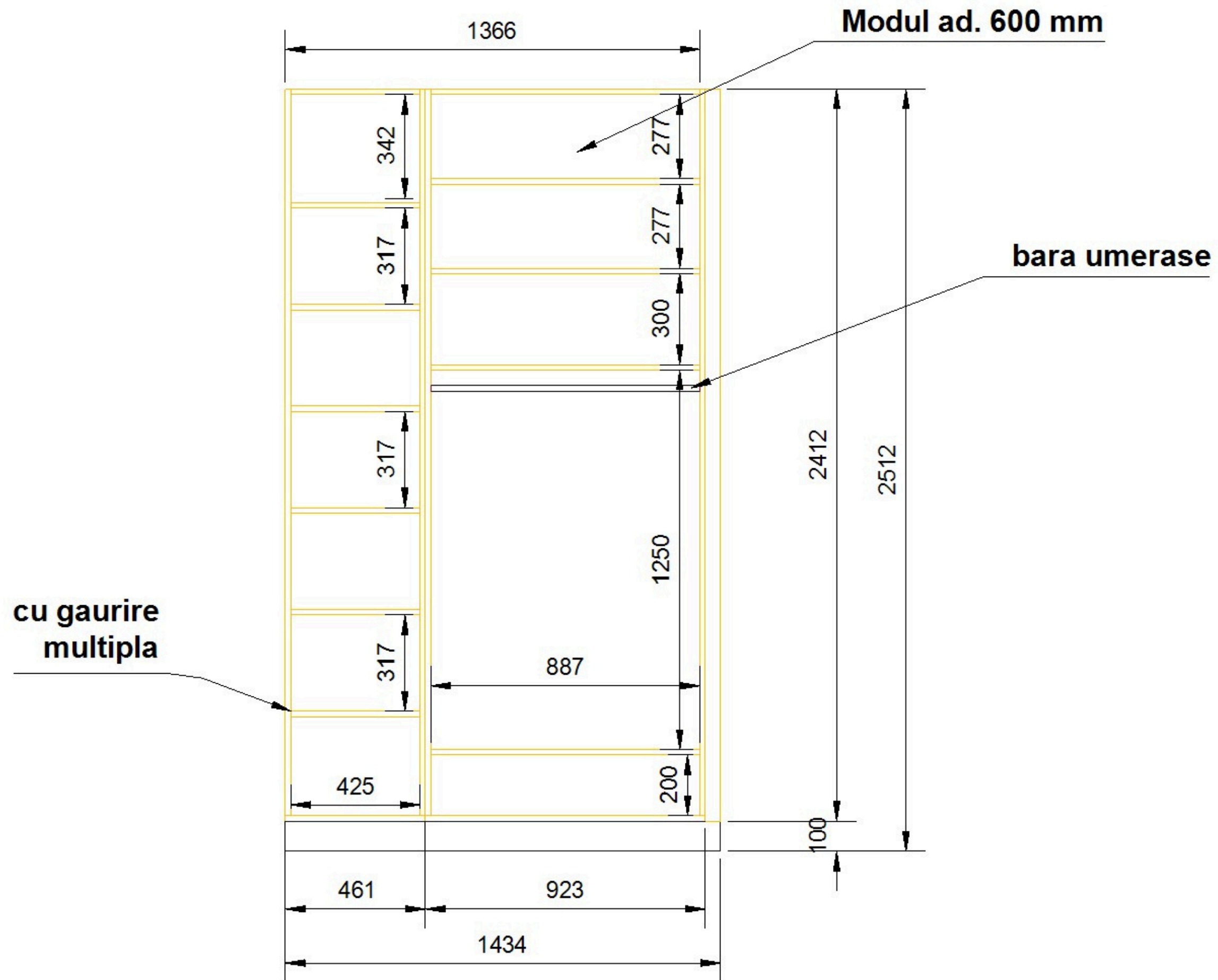

**Rog a se respecta
cotele inerioare intre
polite!**

Insula

- Modul insula cu perna tapitata rabatabila: H 500 mm x L 700 mm x Ad 450 mm



Insula

tapiterie

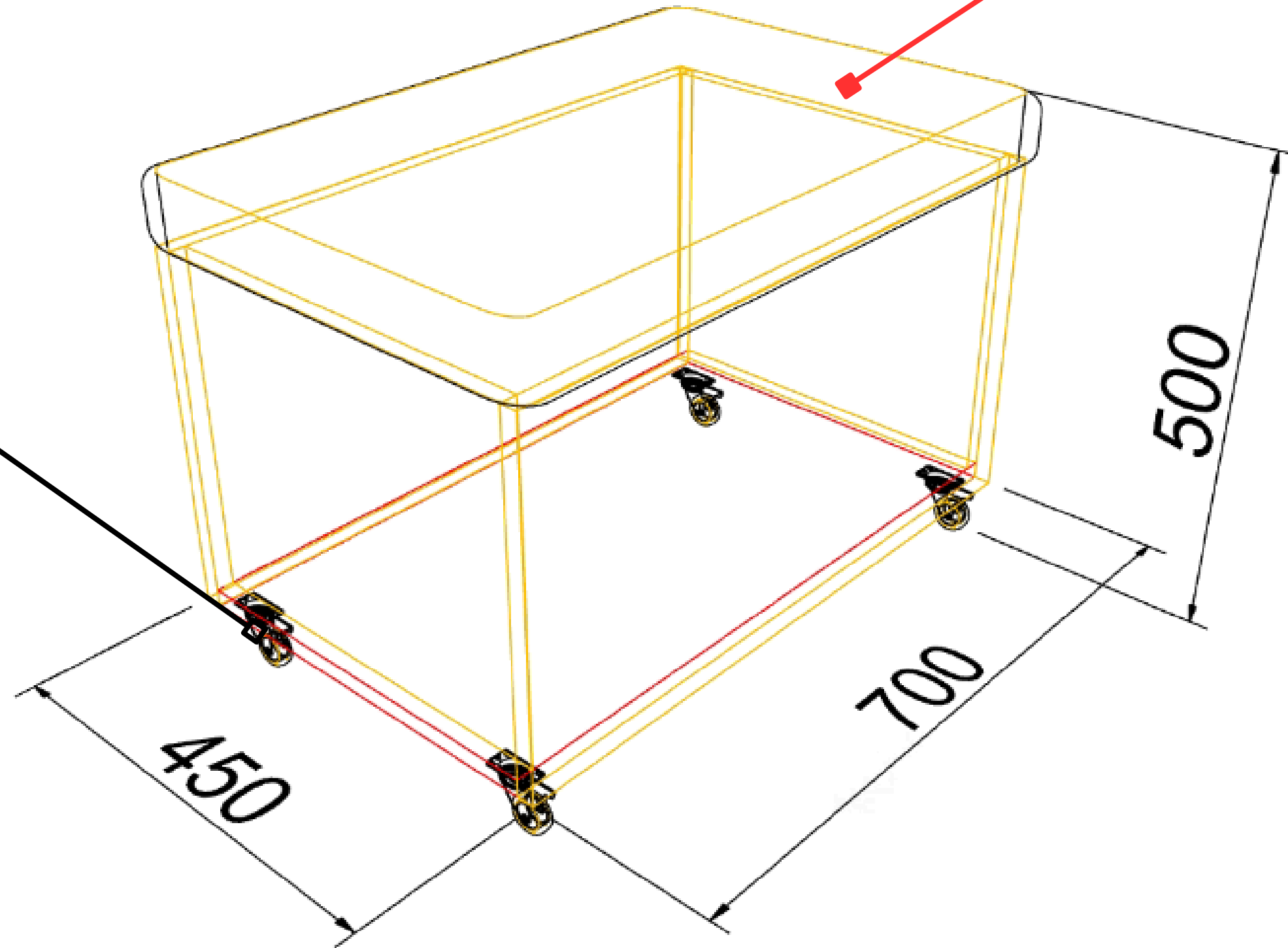

material utilizat:
W1200 ST9

INSULA

Vedere laterala

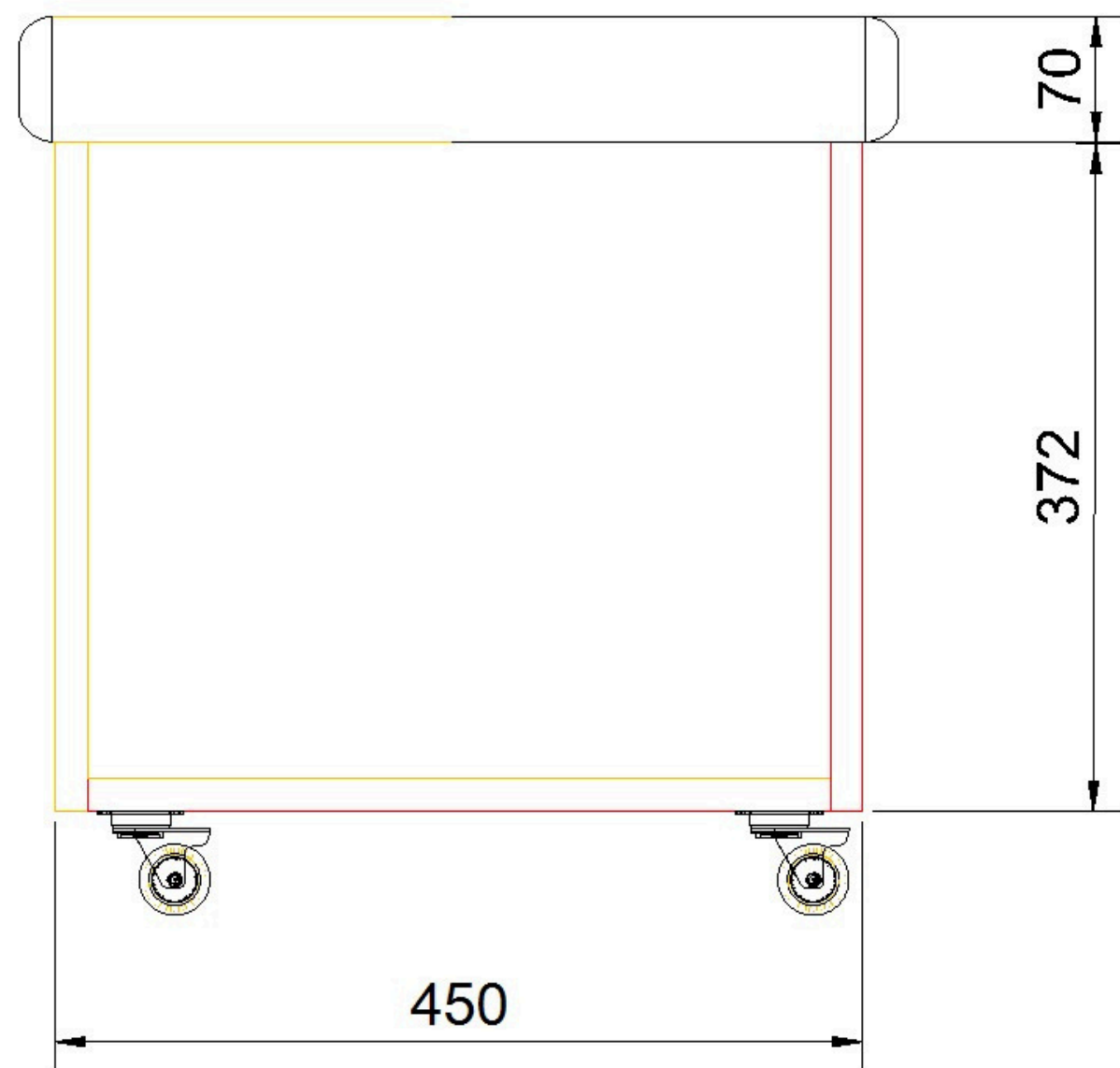

INSULA

Vedere frontala

tapiterie

